

- To the outdoor unit, up to two indoor units can be connected until the total nominal cooling capacity not more than 5.0 kW (RAM-G36N2HAE), 6.0 kW (RAM-G43N2HAE).
- The pipe connection ports of the outdoor unit and connectable indoor units are shown above.

- Please mount the Outdoor unit on stable ground to prevent vibration and increase of noise level.
- Decide the location for piping after sorting out the different types of pipe available.
- When removing side cover, please pull the handle after undoing the hook by pulling it downward.

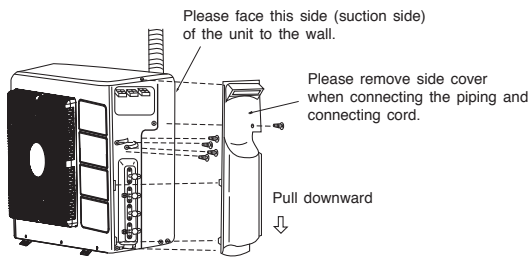

CONDENSED WATER DISPOSAL OF OUTDOOR UNIT

- There are holes on the base of Outdoor unit for condensed water to exhaust.
- In order to flow condensed water to the drain, the unit is installed on a stand or a block so that the unit is 100mm above the ground as shown figure. Join the drain pipe to one hole.
- At first insert one portion of the hook to the base (Portion A), then pull the drain pipe in the direction shown by the arrow while inserting the hook into the base. After installation, check whether the drain pipe cling to the base firmly.

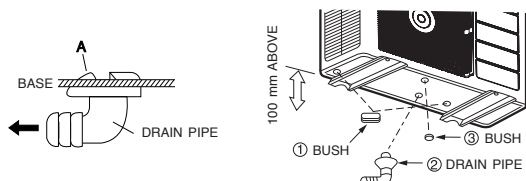

When Using and Installing In Cold Areas

When the air conditioner is used in low temperature and in snowy conditions, water from the heat exchanger may freeze on the base surface to cause poor drainage. When using the air conditioner in such areas, do not install the bushings. Keep a minimum of 250mm between the drain hole and the ground. When using the drain pipe, consult your sales agent.

※ For more details, refer to the installation Manual for Cold Areas.

1 Preparation of Pipe

- Use a pipe cutter to cut the copper pipe.



CAUTION

- Jagged edge will cause leakage.
- Point the side to be trimmed downwards during trimming to prevent copper chips from entering the pipe.

- Before flaring, please put on the flare nut.

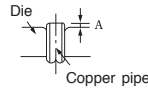

- Recommend to use R32 flaring tool.

Outer Diameter mm (inch)	Thickness (mm)	A (mm)		
		Flare tool for R32 Clutch type	Conventional flare tool Clutch type Wing nut type	
6.35 (1/4")	0.8	0.0 ~ 0.5	1.0 ~ 1.5	1.5 ~ 2.0
9.52 (3/8")	0.8	0.0 ~ 0.5	1.0 ~ 1.5	1.5 ~ 2.0
12.70 (1/2")	0.8	0.0 ~ 0.5	1.0 ~ 1.5	1.5 ~ 2.5

2 Pipe Connection

CAUTION

In case of removing flare nut of an Indoor unit, first remove a nut of small diameter side, or a seal cap of big diameter side will fly out. Prevent water from entering into the piping when working.

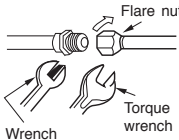

		Outer dia. of pipe	Torque N·m (kgf·cm)
Small dia. side	Small dia. side	6.35 (1/4")	14.0 ~ 18.0 (140 ~ 180)
	Large dia. side	9.52 (3/8")	33.0 ~ 42.0 (330 ~ 420)
	Large dia. side	12.70 (1/2")	50.0 ~ 62.0 (500 ~ 620)
Valve head cap	Small dia. side	6.35 (1/4")	19.6 ~ 24.5 (200 ~ 250)
	Large dia. side	9.52 (3/8")	19.6 ~ 24.5 (200 ~ 250)
	Large dia. side	12.7 (1/2")	29.4 ~ 34.3 (300 ~ 350)
Valve core cap			12.3 ~ 15.7 (125 ~ 160)
Spindle	Small dia. side	6.35 (1/4")	3.92~5.88 (40~60)
	Large dia. side	9.52 (3/8")	
	Large dia. side	12.7 (1/2")	9.80~10.78 (100~110)

3 Removal Of Air From The Pipe And Gas Leakage Inspection

Procedures of using Vacuum Pump for Air Removal

As shown in right figure, remove the cap of valve core. Then, connect the charge hose. Remove the cap of valve head. Connect the vacuum pump adapter to the vacuum pump and connect the charge hose to the adapter.

Fully tighten the "Hi" knob of the manifold valve and completely unscrew the "Lo" knob. Run the vacuum pump for about 10~15 minutes, then completely tighten the "Lo" knob and switch off the vacuum pump.

Remove the charge hose and tighten the cap of valve core. Check the cap's periphery if there is any gas leakage.

Completely unscrew the spindle of the service valve in anti-clockwise direction to allow the flow of refrigerant (using Hexagonal Wrench key).

Re-cap the service valve and tighten using wrench. Check the cap's periphery if there is any gas leakage. The task is then completed.

When the meter reaches - 101KPa (-76cmHg) during pumping, fully tighten the shuttle.

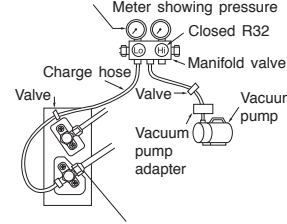

When pumping starts, slightly loosen the flare nut to check of air sucked in. Then tighten the flare nut.

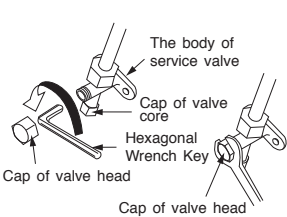

CAUTION

- Prevent moisture from entering pipe connection.
- Refrigerating machine oil not be applied to the outside of the flare.
- When refrigerating machine oil is applied to the outside of the flare, excessive tightening of the flare nut, cracking of the flare nut, destruction of the flare and gas leakage may occur.
- When using the control valve, do not use deteriorated packing. And, do not overtighten the steering wheel.
- Gas leakage from the service valve part, stagnation, touching fire, rarely cause ignition.

Gas Leakage Inspection

Please use gas leakage detector to check if leakage occurs at the connection of Flare nut as shown on the right.

If gas leakage occurs, further tighten the connection to stop leakage. (Be sure to use R32 detector)

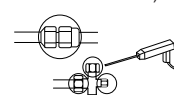

WARNING • THIS APPLIANCE MUST BE EARTHED.

Procedures of Wiring

1. Installation procedure and notice

Especially, the selection of installation place need great care for the split type air conditioner, because it is very difficult to move from place to place after the first installation.

1.1 Wiring

- Connect the electrical wiring between the Indoor and Outdoor unit, as shown in Fig. 1-1. Never connect the wiring by mistake.
- In case of wrong connection, the unit does not operate properly and it may cause malfunction.
- The connecting cord must be fixed by the band which is located near the terminal board.

1.2 Connection of the connecting cords and power cord

- Cut off the connecting cord, the power cord and strip the insulation of the wire, as shown in Fig. 1-2.
- Connect the connecting cord and power cord to the terminal board. (Fig. 1-3)
- Fix the connecting cords and power cord with steel band certainly. (Fig. 1-3)

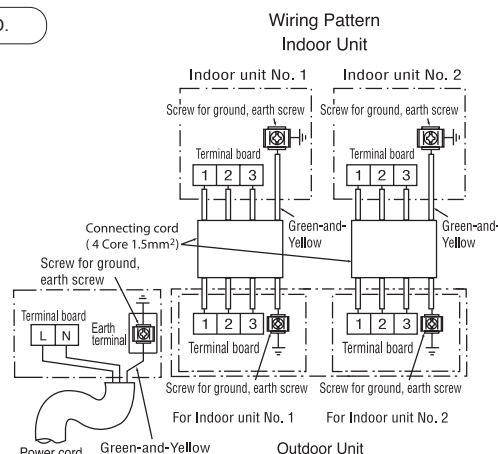
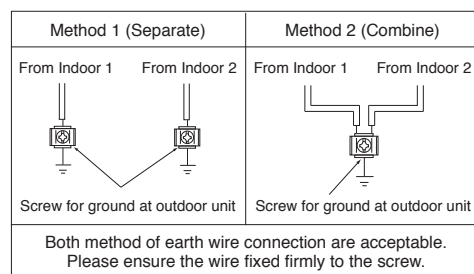

Fig. 1-1

Indoor earth wire connection to outdoor



Both method of earth wire connection are acceptable. Please ensure the wire fixed firmly to the screw.

WARNING

- Leave some space in the connecting cord for maintenance purpose and be sure to secure it with the cord band.
- Secure the connecting cord along the coated part of the wire using the cord band. Do not exert pressure on the wire as this may cause overheating or fire.

Wiring of The Outdoor Unit

- Please remove the side plate for wire connection.

WARNING

- If you cannot attach the side plate due to the connection cord, please press the connecting cord in the direction to the front panel to fix it.
- Be sure that the hooks of the side plate is fixed in certainly. Otherwise water leakage may occur and this causes short circuit or faults.
- The connecting cord should not touch to service valve and pipes. (It becomes high temperature in heating operation.)

Checking for the electric source and the voltage range

- Before installation, the power source must be checked and necessary wiring work must be completed. To make the wiring capacity proper, use the wire gauge list below for the wiring from house distribution fuse box to the outdoor unit in consideration of the locked rotor current.
- Investigate the power supply capacity and other electrical conditions at the installing location.
- Depending on the model of room air conditioner to be installed, request the customer to make arrangements for the necessary electrical work etc.
- The electrical work includes the wiring work up the outdoor unit. In localities where electrical conditions are poor, use of a voltage regulation is recommended.
- Install outdoor for the room air conditioner within the reaching range of the line cord.

IMPORTANT

For (Power cord - L, N, Earth)

Cable type	Wire cross-section
3 Core	2.5mm²

For (Connecting cord - 1, 2, 3, Earth)

Cable type	Wire cross-section	Cable length
4 Core	1.5mm²	up to 25m

Bind connecting cords to make them fit between the convex sections.

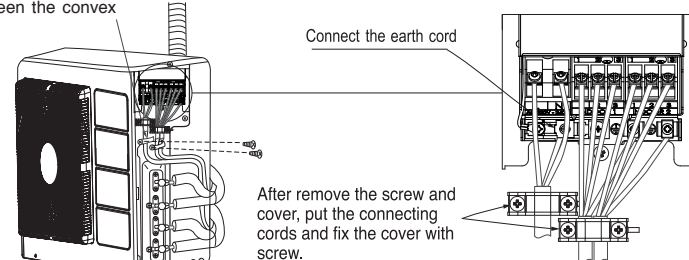

Fig. 1-3

Type of grounding rod	Length
SP-EB-2	900mm

Grounding rod (optional)
(Earth wire and grounding rod are not supplied. Please use optional items below.)

IMPORTANT

Circuit Breaker
16A

CAUTION

Arrange power cord so they do not touch service valve.

CAUTION

Note:
• Outdoor supply cords shall not be lighter than polychloroprene sheathed flexible cord with code designation 60245 IEC 57.

1 Insulation And Maintenance Of Pipe Connection

- The connected terminals should be completely sealed with heat insulator and then tied up with rubber strap.
- Please tie the pipe and power line together with vinyl tape. As shown in the figure showing the installation of Indoor and Outdoor units. Then fix their position with holders.
- To enhance the heat insulation and to prevent water condensation, please cover the outdoor part of the drain hose and pipe with insulation pipe.
- Completely seal any gap with putty.

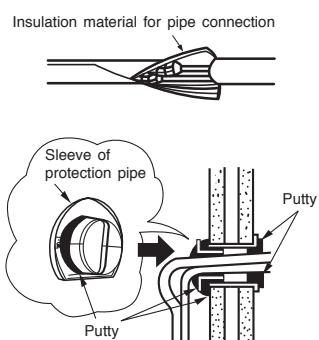

2 Power Source And Operation Test

Power Source

WARNING

- Never remodel the power plug nor extend the long-distance cord.
- Keep additional length for the power cord and do not render the plug under external force as this may cause poor contact.
- Do not fix the power cord with U-shape nail.
- The power cable easily generates heat. Do not bring the cable together with a wire or vinyl tie.

Operation Test

- Please be sure to measure the supply voltage before operation test.
- Please ensure that the air conditioner is in normal operating condition during the operation test.
- 1. Operate with Cool Mode(in summer) or Heat Mode(in winter).
- 2. Press Temperature Button on the remote controller to set the desired temperature to 16.0°C for Cool Mode or 32.0°C for Heating Mode.

Set the desired fan speed to " (High)."

- Operate the air conditioner for 20 minutes at least and make sure that the air from the air conditioner is cool or warm.
- Press the ON/Off button on the remote controller to make sure that the air conditioner stops running.
- If the indication lamps of the indoor unit blink with sounding the buzzer during the operation test, perform a check following the procedures below.

Indication lamps blinking mode	What do check
All indication lamps blink three times repeatedly.	Make sure that the spindles of both service valves are open. (Outdoor fan might operate for near 15 minutes after the operation stop for the protection. For the reoperation at that case, do it after outdoor fan will stop.)

- Before the check and the reoperation, reset the power supply by turning off and on the circuit breaker only after:-
- 1. waiting for at least 5 mints; or
- 2. pressing the Temporary Switch Button only once while the power is OFF.

CAUTION

- Don't operate for over 5 minutes with the situation that the spindle of the service valve is closed. This will cause the defect.
- Don't operate by Cool Mode or Dry Mode with the door and windows opened, (the room humidity is always above 80%) for a long period of time. Water will condense and drip down occasionally. This will wet your furniture.

- Explain to your customer the proper operation procedures as described in the user's manual.
- If the indoor unit won't operate, check the cable for correct connection.
- Turn on the lamp in the room where the indoor unit is installed and check the remote controller for normal operation.

CAUTION

- Trial run should be conducted on one unit at a time to check for incorrect wiring of connecting cord.

INSTALLATION MANUAL

airHome
MultiPro

SPLIT UNIT AIR CONDITIONER

OUTDOOR UNIT
RAM-G55N2HAE



EN INSTRUCTION MANUAL

FOR SERVICE PERSONNEL ONLY

- Carefully read through the procedures of proper installation before starting installation work.
- The sales agent should inform customers regarding the correct operation of installation.

Tools Needed For Installation Work

- (●) mark is tool exclusive use for R32
- ● Screwdriver ● Measuring Tape
- Knife ● Saw ● Pipe Cutter
- Hexagonal Wrench Key (4mm)
- Power Drill (φ 65mm ~ φ 90mm)
- Vacuum Pump ● Pliers or Wrench
- Torque Wrench ● Vacuum Pump Adaptor
- Flare Tool ● Gas Leakage Detector
- Manifold Valve ● Charge Hose
- Reamer ● File

SAFETY PRECAUTION

- Read the safety precautions carefully before operating the unit.
- The contents of this section are vital to ensure safety. Please pay special attention to the following sign.

WARNING Incorrect methods of installation may cause death or serious injury.

CAUTION Improper installation may result in serious consequence.

Be sure that the unit operates in proper condition after installation. Explain to customer the proper way of operating the unit as described in the user's guide.



Access the full version of the User Installation Manual by scanning the code.

HITACHI

WARNING

- Flare nut must use a torque wrench without fail. Tighten with the specified tightening torque. If the flare nut is tightened too much, after a long period of time, the flare nut breaks, Gas leakage, stagnation, touching fire, rarely cause ignition.
- Sharp bending of the pipe use the polyethylene rod, bend not crushed the pipe. Gas leakage from the crushed part, stagnation, touching fire, rarely cause ignition.
- Please request your sales agent or qualified technician to install your unit. Water leakage, short circuit or fire may occur if you do the installation work yourself.
- Please observe the instructions stated in the installation manual during the process of installation. Improper installation may cause water leakage, electric shock and fire.
- A brazed, welded, or mechanical connection shall be made before opening the valves to permit refrigerant to flow between the refrigerating system parts. A vacuum valve shall be provided to evacuate the interconnecting pipe and/or any uncharged refrigerating system part.
- Mechanical connectors used indoors shall comply with ISO 14903. When mechanical connectors are reused indoors, sealing parts shall be renewed. When flared joints are reused indoors, the flare part shall be re-fabricated.
- Refrigerant tubing shall be protected or enclosed to avoid damage.
- Make sure that the units are mounted at locations which are able to provide full support to the weight of the units. If not, the units may collapse and impose danger.
- Observe the rules and regulations of the electrical installation and the methods described in the installation manual when dealing with the electrical work. Use power cables approved by the authorities of your country.
- Be sure to use the specified wire for connecting the indoor and outdoor units. Please ensure that the connections are tight after the conductors of the wire are inserted into the terminals. Improper insertion and loose contact may cause over-heating and fire.
- Please use the specified components for installation work. Otherwise, the units may collapse or water leakage, electric shock and fire may occur.
- Be sure to use the specified piping set for R32. Otherwise, this may result in broken copper pipes or faults.
- When installing or removing an air conditioner, only specified refrigerant (R32) shall be allowed, do not allow air or moisture to remain in the refrigeration cycle. Otherwise, pressure in the refrigeration cycle may become abnormally high so that a rupture may be caused.
- Be sure to ventilate fully if a refrigerant gas leak while at work. If the refrigerant gas comes into contact with fire, a poisonous gas may occur. Be aware that refrigerants may not contain an odour.
- After completion of installation work, check to make sure that there is no refrigeration gas leakage. If the refrigerant gas leaks into the room, coming into contact with fire in the fan-driven heater, space heater, etc., a poisonous gas may occur.
- Unauthorized modifications to the air conditioner may be dangerous. If a breakdown occurs please call a qualified air conditioner technician or electrician. Improper repairs may result in water leakage, electric shock and fire, etc.

The Choice of Mounting Site (Please note the following matters and obtain permission from customer before installation).

WARNING

- The Outdoor unit must be mounted at a location which can support heavy weight. Otherwise, noise and vibration will increase.

CAUTION

- Do not expose the unit under direct sunshine or rain. Besides, ventilation must be good and clear of obstruction.
- The air blown out of the unit should not point directly to animals or plants.
- The clearances of the unit from top, left, right and front are specified in figure below. At least 3 of the above sides must be open air.
- Be sure that the hot air blown out of the unit and noise do not disturb the neighbourhood.
- Do not install at a location where there is flammable gas, steam, oil and smoke.
- The location must be convenient for water drainage.
- Place the Outdoor unit and its connecting cord at least 1m away from the antenna or signal line of television, radio or telephone. This is to avoid noise interference.
- Do not install outdoor unit facing strong wind direction. It may damage the fan motor.
- Do not install the outdoor unit in a place where small animals may build their nests. If small animal goes inside the unit and touches the electrical parts, failure of the unit, smoke or fire may be caused. Request your customer to keep the surrounding of the unit is clean.

Names of Outdoor Components

No.	Item	Qty	Dimension of Mounting Stand of the Outdoor unit (unit : mm)
①	Bush	3	
②	Drain Pipe	1	
③	Bush	1	

Figure showing the Installation of Outdoor Unit.

CAUTION

- This unit is chargeless up 35m pipe length.
- Installation of pipe length less than minimum pipe length requirement (3 meters) may generate an abnormal sound.

WARNING

This symbol shows that this equipment uses a flammable refrigerant.
If the refrigerant is leaked, together with an external ignition source, there is a possibility of ignition.

CAUTION

This symbol shows that the Operation Instructions should be read carefully.

CAUTION

This symbol shows that a service personnel should be handling this equipment with reference to the Installation Manual.

CAUTION

This symbol shows that there is information included in the Operation Manual and/or Installation Manual

WARNING

BURST HAZARD
Do not allow air, etc. to get into refrigerant cycle (piping)

RISK OF EXPLOSION
Compressor must be stopped before removing refrigerant pipes.
All service valve must be fully closed after pumping down operation.

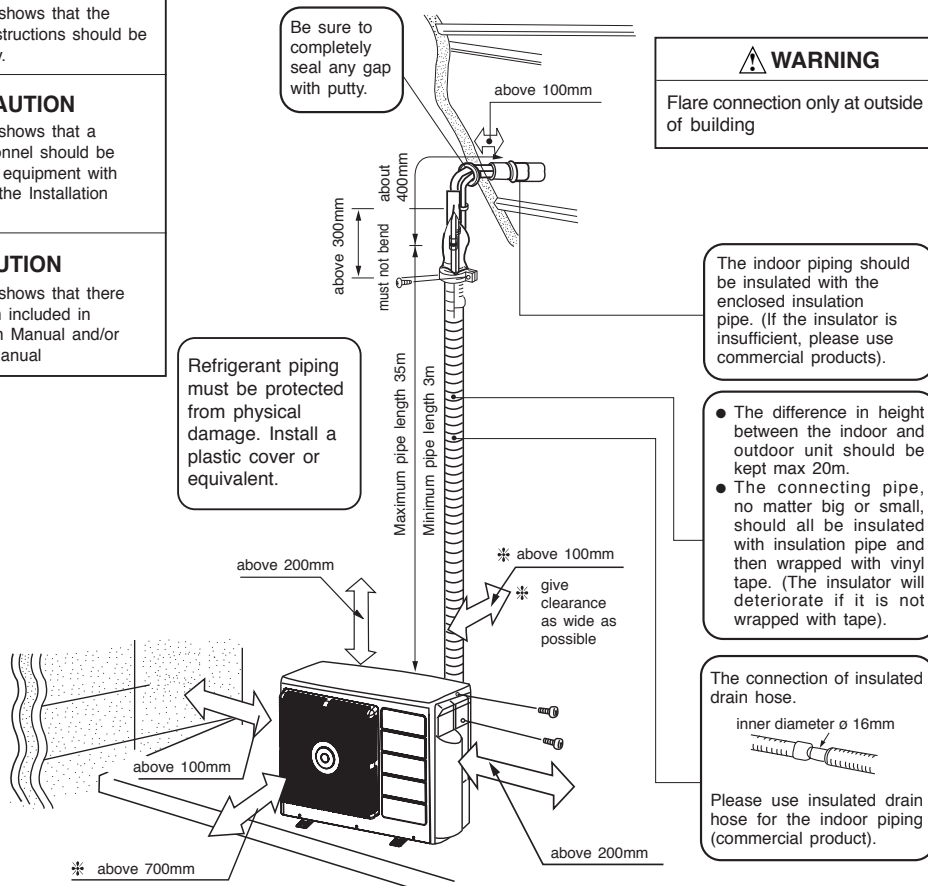

CAUTION

- A circuit breaker or fuse must be installed. Without a circuit breaker or fuse the danger of electric shock exists. The external switch shall be incorporated to completely disconnect from power supply. It should disconnect all poles, and a contact separation of at least 3mm must be present.
- Do not install the unit near a location where there is flammable gas. The outdoor unit may catch fire if flammable gas leaks around it.
- Do not install the indoor unit in a machine shop or kitchen where vapor from oil or its mist flows to the indoor unit. The oil will deposit on the heat exchanger, thereby reducing the indoor unit performance and may deform and in the worst case, break the plastic parts of the indoor unit.
- Please ensure smooth flow of water when installing the drain hose.
- Piping shall be suitable supported with a maximum spacing of 1m between the supports.

WARNING

- Do not use means to accelerate the defrosting process or to clean, other than those recommended by the manufacturer. Any unfit method or using incompatible material may cause product damage, burst and serious injury.
- The appliance/pipe-work shall be stored in a well ventilated room with indoor floor area larger than A_{min} [refer to Table 1] and without any continuously operating ignition source. Keep away from open flames, any operating gas appliances or any operating electric heater. Else, it may explode and cause injury or death.
- The appliance/pipe-work shall be installed, and/or operated in a room with floor area larger than A_{min} [refer to Table 1] and keep away from ignition sources, such as heat/spark/open flame or hazardous areas such as gas appliances, gas cooking, reticulated gas supply systems or electric cooking appliances, etc.
- Do not pierce or burn as the appliance/pipe-work is pressurized. Do not expose the appliance/pipe-work to heat, flame, sparks, or other sources of ignition. Else, it may explode and cause injury or death.

1. Proper place for installation

1.1 Outdoor unit

- (1) Keep the space around the unit for maintenance and avoiding the effects of hindrance for normal ventilation of the unit.
- (2) The northern or eastern side of the building is better to install. At the installation on the southern or western side unavoidably, some blind should be set up for the unit. (In this case, the blind must not obstruct the ventilation of the unit.)
- (3) You'd better not put the unit at a place where is full of dirt and at a place where is wet in the rain.
- (4) Place as near as possible to the indoor unit.
- (5) Install the unit in a stable place to minimize vibration or noise.
- (6) After arranging the cords and pipes, secure them in place.

WARNING

- This appliance must be earthed.
- Power is supplied through outdoor unit, do not connect power source to indoor unit.

- (2) In the electrical installation a separator with a contact gap of more than 3mm has to be installed. During cleaning or service the set has to be switched off with this separator.

<IA2321: A>

CAUTION

- Make sure to connect to two or three indoor units.

Flare adaptor for piping

The flare adaptor for piping is required depending on combination of indoor units.
● ø9.52(3/8") → ø 12.7 (1/2")
Parts number TA261D-4 001

- Please mount the Outdoor unit on stable ground to prevent vibration and increase of noise level.
- Decide the location for piping after sorting out the different types of pipe available.
- When removing side cover, please pull the handle after undoing the hook by pulling it downward.

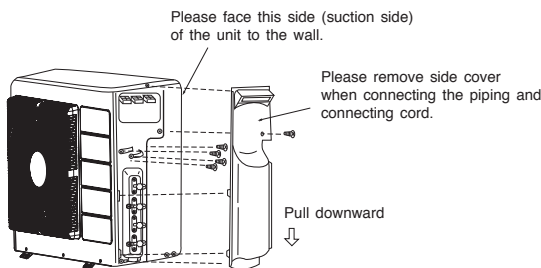

CONDENSED WATER DISPOSAL OF OUTDOOR UNIT

- There are holes on the base of Outdoor unit for condensed water to exhaust.
- In order to flow condensed water to the drain, the unit is installed on a stand or a block so that the unit is 100mm above the ground as shown figure. Join the drain pipe to one hole.
- At first insert one portion of the hook to the base (Portion A), then pull the drain pipe in the direction shown by the arrow while inserting the hook into the base. After installation, check whether the drain pipe cling to the base firmly.

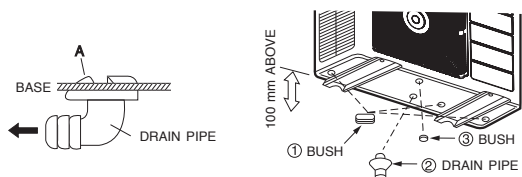

When Using and Installing In Cold Areas

When the air conditioner is used in low temperature and in snowy conditions, water from the heat exchanger may freeze on the base surface to cause poor drainage. When using the air conditioner in such areas, do not install the bushings. Keep a minimum of 250mm between the drain hole and the ground. When using the drain pipe, consult your sales agent.

※ For more details, refer to the installation Manual for Cold Areas.

1 Preparation of Pipe

- Use a pipe cutter to cut the copper pipe.



CAUTION

- Jagged edge will cause leakage.
- Point the side to be trimmed downwards during trimming to prevent copper chips from entering the pipe.

- Before flaring, please put on the flare nut.

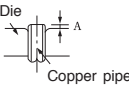
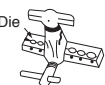

- Recommend to use R32 flaring tool.

Outer Diameter mm (inch)	Thickness (mm)	A (mm)		
		Flare tool for R32 Clutch type	Conventional flare tool Clutch type	Wing nut type
6.35 (1/4")	0.8	0.0 ~ 0.5	1.0 ~ 1.5	1.5 ~ 2.0
9.52 (3/8")	0.8	0.0 ~ 0.5	1.0 ~ 1.5	1.5 ~ 2.0
12.70 (1/2")	0.8	0.0 ~ 0.5	1.0 ~ 1.5	1.5 ~ 2.5

2 Pipe Connection

CAUTION

In case of removing flare nut of an Indoor unit, first remove a nut of small diameter side, or a seal cap of big diameter side will fly out. Prevent water from entering into the piping when working.

		Outer dia. of pipe	Torque N·m (kgf·cm)
Small dia. side		6.35 (1/4")	14.0 ~ 18.0 (140 ~ 180)
Large dia. side		9.52 (3/8") 12.70 (1/2")	33.0 ~ 42.0 (330 ~ 420) 50.0 ~ 62.0 (500 ~ 620)
	Small dia. side	6.35 (1/4")	19.6 ~ 24.5 (200 ~ 250)
	Large dia. side	9.52 (3/8") 12.7 (1/2")	19.6 ~ 24.5 (200 ~ 250) 29.4 ~ 34.3 (300 ~ 350)
Valve core cap			12.3 ~ 15.7 (125 ~ 160)
Spindle	Small dia. side	6.35 (1/4") 9.52 (3/8")	3.92~5.88 (40~60)
	Large dia. side	12.7 (1/2") 15.87 (5/8")	9.80~10.78 (100~110)

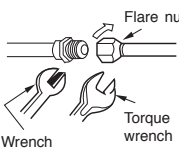

3 Removal Of Air From The Pipe And Gas Leakage Inspection

Procedures of using Vacuum Pump for Air Removal

As shown in right figure, remove the cap of valve core. Then, connect the charge hose. Remove the cap of valve head. Connect the vacuum pump adapter to the vacuum pump and connect the charge hose to the adapter.

Fully tighten the "Hi" knob of the manifold valve and completely unscrew the "Lo" knob. Run the vacuum pump for about 10~15 minutes, then completely tighten the "Lo" knob and switch off the vacuum pump.

Remove the charge hose and tighten the cap of valve core. Check the cap's periphery if there is any gas leakage.

Completely unscrew the spindle of the service valve in anti-clockwise direction to allow the flow of refrigerant (using Hexagonal Wrench key).

Re-cap the service valve and tighten using wrench. Check the cap's periphery if there is any gas leakage. The task is then completed.

When the meter reaches - 101KPa (-76cmHg) during pumping, fully tighten the shuttle.

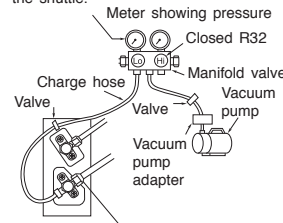

When pumping starts, slightly loosen the flare nut to check of air sucked in. Then tighten the flare nut.

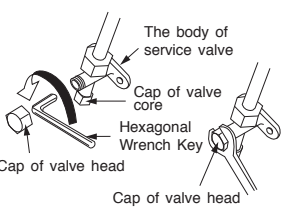

Gas Leakage Inspection

Please use gas leakage detector to check if leakage occurs at the connection of Flare nut as shown on the right.

If gas leakage occurs, further tighten the connection to stop leakage. (Be sure to use R32 detector)

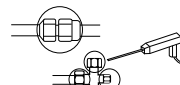

CAUTION

- Prevent moisture from entering pipe connection.
- Refrigerating machine oil not be applied to the outside of the flare. When refrigerating machine oil is applied to the outside of the flare, excessive tightening of the flare nut, cracking of the flare nut, destruction of the flare and gas leakage may occur.
- When using the control valve, do not use deteriorated packing. And, do not overtighten the steering wheel. Gas leakage from the service valve part, stagnation, touching fire, rarely cause ignition.

Wiring of The Outdoor Unit

- Please remove the side cover for wire connection.

WARNING

- If you cannot attach the side cover due to the connecting cord, press the connecting cord in direction to the front panel to fix it.
- Be sure that the hooks of the side cover is fixed in certainly. Otherwise water leakage may occur and this causes short circuit or faults.
- The connecting cord should not touch to service valve and pipes. (It becomes high temperature in heating operation.)

Checking for the electric source and the voltage range

- Before installation, the power source must be checked and necessary wiring work must be completed. To make the wiring capacity proper, use the wire gauges list below for the lead-in from a pole transformer and for the wiring from a switch board of fuse box to the main switch and outdoor unit in consideration of the locked rotor current.
- Investigate the power supply capacity and other electrical conditions at the installing location. Depending on the model of room air conditioner to be installed, request the customer to make arrangements for the necessary electrical work etc. The electrical work includes the wiring work up the outdoor unit. In localities where electrical conditions are poor, use of a voltage regulation is recommended.

IMPORTANT

For (Power cord - L, N, Earth)

Cable type	Wire cross-section
3 Core	2.5mm ²

For (Connecting cord - 1, 2, 3, Earth)

Cable type	Wire cross-section	Cable length
4 Core	1.5mm ²	up to 25m

Bind connecting cords to make them fit between the convex sections.

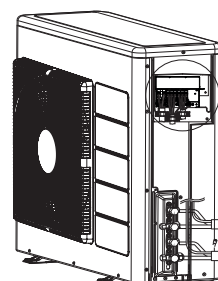

Connect the earth cord

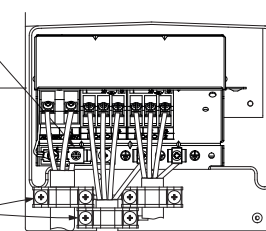

Fig. 1-3

CAUTION

Arrange power cord so they do not touch service valve.

CAUTION

Note:
• Outdoor supply cords shall not be lighter than polychloroprene sheathed flexible cord with code designation 60245 IEC 57.

IMPORTANT

Circuit Breaker
16A

Grounding rod (optional)

(Earth wire and grounding rod are not supplied. Please use optional items below.)

Circuit Breaker
16A

WARNING • THIS APPLIANCE MUST BE EARTHED.

Procedures of Wiring

1. Installation procedure and notice

Especially, the selection of installation place need great care for the split type air conditioner, because it is very difficult to move from place to place after the first installation.

1.1 Wiring

- Connect the electrical wiring between the Indoor and Outdoor unit, as shown in Fig. 1-1. Never connect the wiring by mistake. In case of wrong connection, the unit does not operate properly and it may cause malfunction.
- The connecting cord must be fixed by the band which is located near the terminal board.

1.2 Connection of the connecting cords and power cord

- Cut off the connecting cord, the power cord and strip the insulation of the wire, as shown in Fig. 1-2.
- Connect the connecting cord and power cord to the terminal board. (Fig. 1-3)
- Fix the connecting cords and power cord with steel band certainly. (Fig. 1-3)

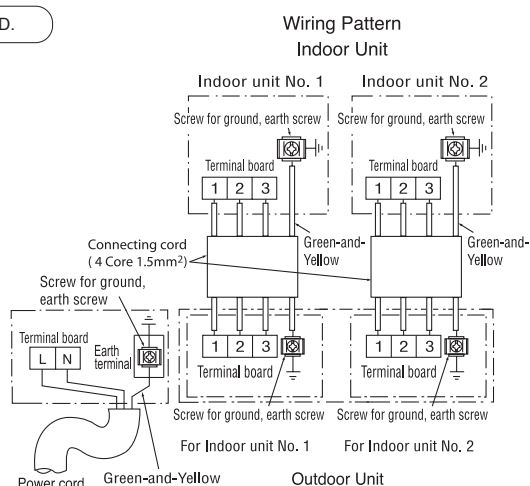
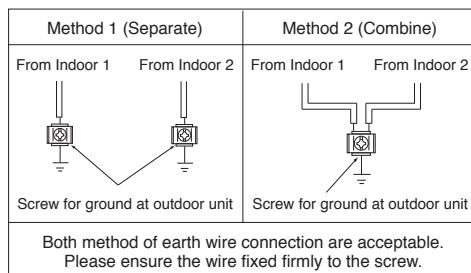

Fig. 1-1

Indoor earth wire connection to outdoor



WARNING

- Leave some space in the connecting cord for maintenance purpose and be sure to secure it with the cord band.
- Secure the connecting cord along the coated part of the wire using the cord band. Do not exert pressure on the wire as this may cause overheating or fire.

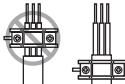

WARNING

- The naked part of the wire core should be 10 mm and fix it to the terminal tightly. Then try to pull the individual wire to check if the contact is tight. Improper insertion may burn the terminal.
- Be sure to use only wire specified for the use of air-conditioner.
- Please refer to the manual for wire connection and the wiring technique should meet the standard of the electrical installation.
- There is an AC voltage drop between the LN terminal if the power is on. Therefore, be sure to remove the plug from its socket.

Detail of Cutting the Connecting Cord

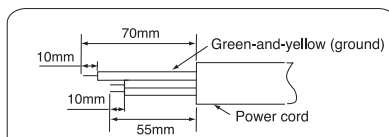

Detail of cutting power cord

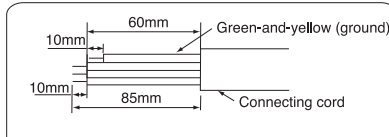

For Indoor Unit No. 1 (1, 2, 3) and Indoor Unit No. 2 (1, 2, 3)

Fig. 1-2

1 Insulation And Maintenance Of Pipe Connection

- The connected terminals should be completely sealed with heat insulator and then tied up with rubber strap.
- Please tie the pipe and power line together with vinyl tape as shown in the figure showing the installation of Indoor and Outdoor units. Then fix their position with holders.
- To enhance the heat insulation and to prevent water condensation, please cover the outdoor part of the drain hose and pipe with insulation pipe.
- Completely seal any gap with putty.

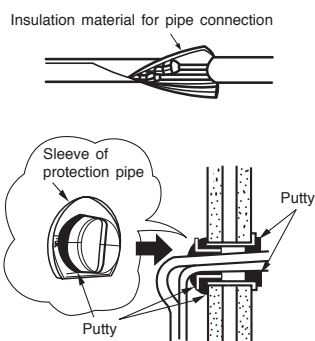

2 Power Source And Operation Test

Power Source

WARNING

- Never remodel the power plug nor extend the long-distance cord.
- Keep additional length for the power cord and do not render the plug under external force as this may cause poor contact.
- Do not fix the power cord with U-shape nail.
- The power cable easily generates heat. Do not bring the cable together with a wire or vinyl tie.

Operation Test

- Please be sure to measure the supply voltage before operation test.
- Please ensure that the air conditioner is in normal operating condition during the operation test.
 - Operate with Cool Mode (in summer) or Heat Mode (in winter).
 - Press Temperature Button on the remote controller to set the desired temperature to 16.0°C for Cool Mode or 32.0°C for Heating Mode.

Set the desired fan speed to " (High)."

- Operate the air conditioner for 20 minutes at least and make sure that the air from the air conditioner is cool or warm.
- Press the ON/OFF button on the remote controller to make sure that the air conditioner stops running.
- If the indication lamps of the indoor unit blink with sounding the buzzer during the operation test, perform a check following the procedures below.

Indication lamps blinking mode	What to do check
All indication lamps blink three times repeatedly.	Make sure that the spindles of both service valves are open. (Outdoor fan might operate for near 15 minutes after the operation stop for the protection. For the reoperation at that case, do it after outdoor fan will stop.)

- Before the check and the reoperation, reset the power supply by turning off and on the circuit breaker only after:
 - waiting for at least 5 minutes; or
 - pressing the Temporary Switch Button only once while the power is OFF.

CAUTION

- Don't operate for over 5 minutes with the situation that the spindle of the service valve is closed. This will cause the defect.
- Don't operate by Cool Mode or Dry Mode with the door and windows opened, (the room humidity is always above 80%) for a long period of time. Water will condense and drip down occasionally. This will wet your furniture.

- Explain to your customer the proper operation procedures as described in the user's manual.
- If the indoor unit won't operate, check the cable for correct connection.
- Turn on the lamp in the room where the indoor unit is installed and check the remote controller for normal operation.

CAUTION

- Trial run should be conducted on one unit at a time to check for incorrect wiring of connecting cord.

INSTALLATION MANUAL

airHome
MultiPro

SPLIT UNIT AIR CONDITIONER

OUTDOOR UNIT
RAM-G55N3HAE
RAM-G68N3HAE



EN INSTRUCTION MANUAL

FOR SERVICE PERSONNEL ONLY

- Carefully read through the procedures of proper installation before starting installation work.
- The sales agent should inform customers regarding the correct operation of installation.

Tools Needed For Installation Work

- (●) mark is tool exclusive use for R32
- ● Screwdriver ● Measuring Tape
- Knife ● Saw ● Pipe Cutter
- Hexagonal Wrench Key (4mm)
- Power Drill (φ 65mm ~ φ 90mm)
- Vacuum Pump ● Pliers or Wrench
- Torque Wrench ● Vacuum Pump Adaptor
- Flare Tool ● Gas Leakage Detector
- Manifold Valve ● Charge Hose
- Reamer ● File

SAFETY PRECAUTION

- Read the safety precautions carefully before operating the unit.
- The contents of this section are vital to ensure safety. Please pay special attention to the following sign.

WARNING Incorrect methods of installation may cause death or serious injury.

CAUTION Improper installation may result in serious consequence.

Be sure that the unit operates in proper condition after installation. Explain to customer the proper way of operating the unit as described in the user's guide.



Access the full version of the User Installation Manual by scanning the code.

HITACHI

WARNING

- Flare nut must use a torque wrench without fail. Tighten with the specified tightening torque. If the flare nut is tightened too much, after a long period of time, the flare nut breaks, Gas leakage, stagnation, touching fire, rarely cause ignition.
- Sharp bending of the pipe use the polyethylene rod, bend not crushed the pipe. Gas leakage from the crushed part, stagnation, touching fire, rarely cause ignition.
- Please request your sales agent or qualified technician to install your unit. Water leakage, short circuit or fire may occur if you do the installation work yourself.
- Please observe the instructions stated in the installation manual during the process of installation. Improper installation may cause water leakage, electric shock and fire.
- A brazed, welded, or mechanical connection shall be made before opening the valves to permit refrigerant to flow between the refrigerating system parts. A vacuum valve shall be provided to evacuate the interconnecting pipe and/or any uncharged refrigerating system part.
- Mechanical connectors used indoors shall comply with ISO 14903. When mechanical connectors are reused indoors, sealing parts shall be renewed. When flared joints are reused indoors, the flare part shall be re-fabricated.
- Refrigerant tubing shall be protected or enclosed to avoid damage.
- Make sure that the units are mounted at locations which are able to provide full support to the weight of the units. If not, the units may collapse and impose danger.
- Observe the rules and regulations of the electrical installation and the methods described in the installation manual when dealing with the electrical work. Use power cables approved by the authorities of your country.
- Be sure to use the specified wire for connecting the indoor and outdoor units. Please ensure that the connections are tight after the conductors of the wire are inserted into the terminals. Improper insertion and loose contact may cause over-heating and fire.
- Please use the specified components for installation work. Otherwise, the units may collapse or water leakage, electric shock and fire may occur.
- Be sure to use the specified piping set for R32. Otherwise, this may result in broken copper pipes or faults.
- When installing or removing an air conditioner, only specified refrigerant (R32) shall be allowed, do not allow air or moisture to remain in the refrigeration cycle. Otherwise, pressure in the refrigeration cycle may become abnormally high so that a rupture may be caused.
- Be sure to ventilate fully if a refrigerant gas leak while at work. If the refrigerant gas comes into contact with fire, a poisonous gas may occur. Be aware that refrigerants may not contain an odour.
- After completion of installation work, check to make sure that there is no refrigeration gas leakage. If the refrigerant gas leaks into the room, coming into contact with fire in the fan-driven heater, space heater, etc., a poisonous gas may occur.
- Unauthorized modifications to the air conditioner may be dangerous. If a breakdown occurs please call a qualified air conditioner technician or electrician. Improper repairs may result in water leakage, electric shock and fire, etc.

The Choice of Mounting Site (Please note the following matters and obtain permission from customer before installation).

WARNING

- The Outdoor unit must be mounted at a location which can support heavy weight. Otherwise, noise and vibration will increase.

CAUTION

- Do not expose the unit under direct sunshine or rain. Besides, ventilation must be good and clear of obstruction.
- The air blown out of the unit should not point directly to animals or plants.
- The clearances of the unit from top, left, right and front are specified in figure below. At least 3 of the above sides must be open air.
- Be sure that the hot air blown out of the unit and noise do not disturb the neighbourhood.
- Do not install at a location where there is flammable gas, steam, oil and smoke.
- The location must be convenient for water drainage.
- Place the Outdoor unit and its connecting cord at least 1m away from the antenna or signal line of television, radio or telephone. This is to avoid noise interference.
- Do not install outdoor unit facing strong wind direction. It may damage the fan motor.
- Do not install the outdoor unit in a place where small animals may build their nests. If small animal goes inside the unit and touches the electrical parts, failure of the unit, smoke or fire may be caused. Request your customer to keep the surrounding of the unit is clean.

Names of Outdoor Components

No.	Item	Qty	Dimension of Mounting Stand of the Outdoor unit (unit : mm)
①	Bush	3	
②	Drain Pipe	1	
③	Bush	1	

Figure showing the Installation of Outdoor Unit.

CAUTION

- This unit is chargeless up 30m pipe length.
- Installation of pipe length less than minimum pipe length requirement (3 meters) may generate an abnormal sound.

Table 1: Minimum Floor area of the room A_{min} (m²)

Outdoor Model	Piping Length (m)		Max refrigerant charge amount (kg)	Minimum Floor Area of the room A _{min} (m ²)				
				Wall-mounted units	Ceiling cassette-mounted units Duct-mounted units		Floor-standing units	
							*With SPX-RAFGLS	Without SPX-RAFGLS
RAM-G55N3HAE	Standard	35	2.05	3.97	2.66	2.66	3.00	35.77
	Maximum	50	2.08	5.22	3.50	3.50	3.44	47.00
RAM-G68N3HAE	Standard	30	2.05	3.97	2.66	2.66	3.00	35.77
	Maximum	60	2.11	6.64	4.45	4.45	3.88	59.77

* Gas leak sensor be setting as optional parts (SPX-RAFGLS)

WARNING

This symbol shows that this equipment uses a flammable refrigerant. If the refrigerant is leaked, together with an external ignition source, there is a possibility of ignition.

CAUTION

This symbol shows that the Operation Instructions should be read carefully.

CAUTION

This symbol shows that a service personnel should be handling this equipment with reference to the Installation Manual.

CAUTION

This symbol shows that there is information included in the Operation Manual and/or Installation Manual

Be sure to completely seal any gap with putty.

Refrigerant piping must be protected from physical damage. Install a plastic cover or equivalent.

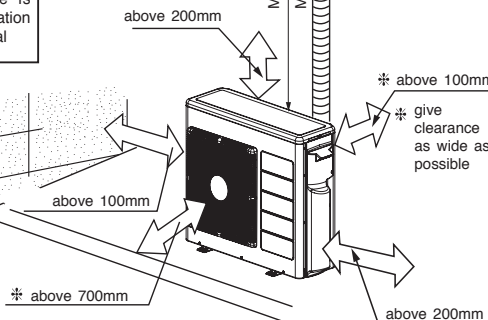

WARNING

Flare connection only at outside of building

The indoor piping should be insulated with the enclosed insulation pipe. (If the insulator is insufficient, please use commercial products).

- The difference in height between the indoor and outdoor unit should be kept max 20m.
- The connecting pipe, no matter big or small, should all be insulated with insulation pipe and then wrapped with vinyl tape. (The insulator will deteriorate if it is not wrapped with tape).

The connection of insulated drain hose.
inner diameter φ 16mm

Please use insulated drain hose for the indoor piping (commercial product).

CAUTION

- A circuit breaker or fuse must be installed. Without a circuit breaker or fuse the danger of electric shock exists. The external switch shall be incorporated to completely disconnect from power supply. It should disconnect all poles, and a contact separation of at least 3mm must be present.
- Do not install the unit near a location where there is flammable gas. The outdoor unit may catch fire if flammable gas leaks around it.
- Do not install the indoor unit in a machine shop or kitchen where vapor from oil or its mist flows to the indoor unit. The oil will deposit on the heat exchanger, thereby reducing the indoor unit performance and may deform and in the worst case, break the plastic parts of the indoor unit.
- Please ensure smooth flow of water when installing the drain hose.
- Piping shall be suitable supported with a maximum spacing of 1m between the supports.

WARNING

- Do not use means to accelerate the defrosting process or to clean, other than those recommended by the manufacturer. Any unfit method or using incompatible material may cause product damage, burst and serious injury.
- The appliance/pipe-work shall be stored in a well ventilated room with indoor floor area larger than A_{min} [refer to Table 1] and without any continuously operating ignition source. Keep away from open flames, any operating gas appliances or any operating electric heater. Else, it may explode and cause injury or death.
- The appliance/pipe-work shall be installed, and/or operated in a room with floor area larger than A_{min} [refer to Table 1] and keep away from ignition sources, such as heat/spark/open flame or hazardous areas such as gas appliances, gas cooking, reticulated gas supply systems or electric cooking appliances, etc.
- Do not pierce or burn as the appliance/pipe-work is pressurized. Do not expose the appliance/pipe-work to heat, flame, sparks, or other sources of ignition. Else, it may explode and cause injury or death.

1. Proper place for installation

1.1 Outdoor unit

- (1) Keep the space around the unit for maintenance and avoiding the effects of hindrance for normal ventilation of the unit.
- (2) The northern or eastern side of the building is better to install. At the installation on the southern or western side unavoidably, some blind should be set up for the unit. (In this case, the blind must not obstruct the ventilation of the unit.)
- (3) You'd better not put the unit at a place where is full of dirt and at a place where is wet in the rain.
- (4) Place as near as possible to the indoor unit.
- (5) Install the unit in a stable place to minimize vibration or noise.
- (6) After arranging the cords and pipes, secure them in place.

WARNING

- This appliance must be earthed.
- Power is supplied through outdoor unit, do not connect power source to indoor unit.

2. In the electrical installation a separator with a contact gap of more than 3mm has to be installed. During cleaning or service the set has to be switched off with this separator.

<IA2327: A>

CAUTION

- Make sure to connect to two or more indoor units.

Flare adaptor for piping

The flare adaptor for piping is required depending on combination of indoor units.

- φ9.52 (3/8") → φ 12.7 (1/2")
Parts number TA261D-4 001
- φ12.7 (1/2") → φ 9.52 (3/8")
Parts number TA261D-6 002

- Please mount the Outdoor unit on stable ground to prevent vibration and increase of noise level.
- Decide the location for piping after sorting out the different types of pipe available.
- When removing side cover, please pull the handle after undoing the hook by pulling it downward.

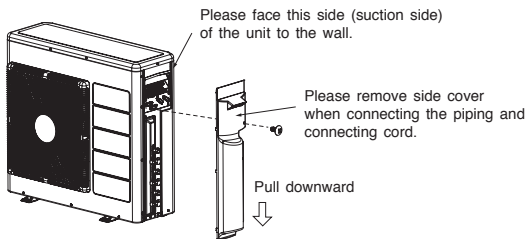

CONDENSED WATER DISPOSAL OF OUTDOOR UNIT

- There are holes on the base of Outdoor unit for condensed water to exhaust.
- In order to flow condensed water to the drain, the unit is installed on a stand or a block so that the unit is 100mm above the ground as shown figure. Join the drain pipe to one hole.
- At first insert one portion of the hook to the base (Portion A), then pull the drain pipe in the direction shown by the arrow while inserting the hook into the base. After installation, check whether the drain pipe cling to the base firmly.

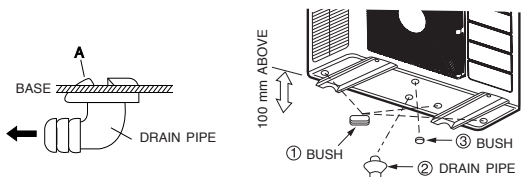

When Using and Installing In Cold Areas

When the air conditioner is used in low temperature and in snowy conditions, water from the heat exchanger may freeze on the base surface to cause poor drainage. When using the air conditioner in such areas, do not install the bushings. Keep a minimum of 250mm between the drain hole and the ground. When using the drain pipe, consult your sales agent.

※ For more details, refer to the installation Manual for Cold Areas.

1 Preparation of Pipe

- Use a pipe cutter to cut the copper pipe.



CAUTION

- Jagged edge will cause leakage.
- Point the side to be trimmed downwards during trimming to prevent copper chips from entering the pipe.

- Before flaring, please put on the flare nut.

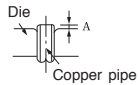

- Recommend to use R32 flaring tool.

Outer Diameter mm (inch)	Thickness (mm)	A (mm)		
		Flare tool for R32 Clutch type	Conventional flare tool Clutch type	
6.35 (1/4")	0.8	0.0 ~ 0.5	1.0 ~ 1.5	1.5 ~ 2.0
9.52 (3/8")	0.8	0.0 ~ 0.5	1.0 ~ 1.5	1.5 ~ 2.0
12.70 (1/2")	0.8	0.0 ~ 0.5	1.0 ~ 1.5	1.5 ~ 2.5

2 Pipe Connection

CAUTION

In case of removing flare nut of an Indoor unit, first remove a nut of small diameter side, or a seal cap of big diameter side will fly out. Prevent water from entering into the piping when working.

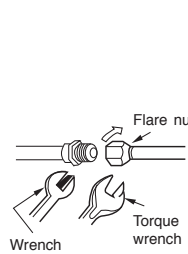

		Outer dia. of pipe	Torque N·m (kgf·cm)
Valve head cap	Small dia. side	6.35 (1/4")	14.0 ~ 18.0 (140 ~ 180)
	Large dia. side	9.52 (3/8")	33.0 ~ 42.0 (330 ~ 420)
Valve core cap	Small dia. side	6.35 (1/4")	19.6 ~ 24.5 (200 ~ 250)
	Large dia. side	9.52 (3/8")	29.4 ~ 34.3 (300 ~ 350)
Spindle	Small dia. side	6.35 (1/4")	3.92~5.88 (40~60)
	Large dia. side	12.7 (1/2")	9.80~10.78 (100~110)

3 Removal Of Air From The Pipe And Gas Leakage Inspection

Procedures of using Vacuum Pump for Air Removal

- As shown in right figure, remove the cap of valve core. Then, connect the charge hose. Remove the cap of valve head. Connect the vacuum pump adapter to the vacuum pump and connect the charge hose to the adapter.

- Fully tighten the "Hi" knob of the manifold valve and completely unscrew the "Lo" knob. Run the vacuum pump for about 10~15 minutes, then completely tighten the "Lo" knob and switch off the vacuum pump.

- Remove the charge hose and tighten the cap of valve core. Check the cap's periphery if there is any gas leakage.

- Completely unscrew the spindle of the service valve in anti-clockwise direction to allow the flow of refrigerant (using Hexagonal Wrench key).

- Re-cap the service valve and tighten using wrench. Check the cap's periphery if there is any gas leakage. The task is then completed.

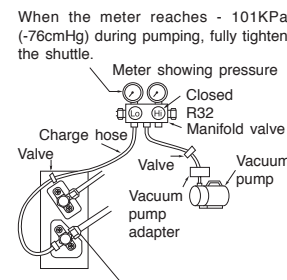

When pumping starts, slightly loosen the flare nut to check of air sucked in. Then tighten the flare nut.

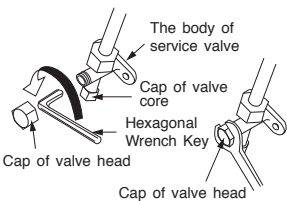

Gas Leakage Inspection

Please use gas leakage detector to check if leakage occurs at the connection of Flare nut as shown on the right.

If gas leakage occurs, further tighten the connection to stop leakage. (Be sure to use R32 detector)

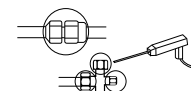

WARNING • THIS APPLIANCE MUST E

Procedures of Wiring

1. Installation procedure and notice

Especially, the selection of installation place need great care for the split type air conditioner, because it is very difficult to move from place to place after the first installation.

1.1 Wiring

- Connect the electrical wiring between the Indoor and Outdoor unit, as shown in Fig. 1-1. Never connect the wiring by mistake. In case of wrong connection, the unit does not operate properly and it may cause malfunction.
- The connecting cord must be fixed by the band which is located near the terminal board.

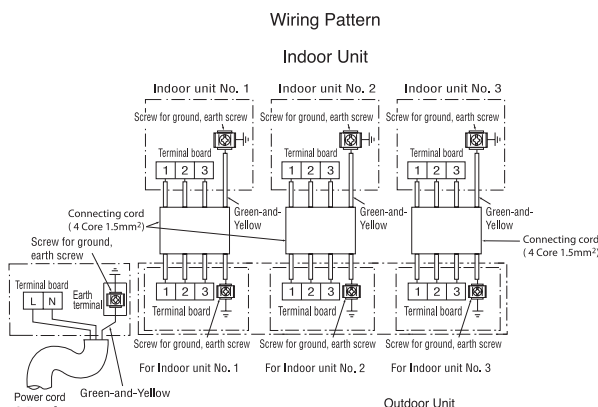
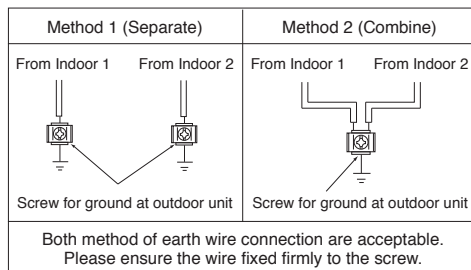

Fig. 1-1

Indoor earth wire connection to outdoor



WARNING

- Leave some space in the connecting cord for maintenance purpose and be sure to secure it with the cord band.
- Secure the connecting cord along the coated part of the wire using the cord band. Do not exert pressure on the wire as this may cause overheating or fire.

Wiring of The Outdoor Unit

- Please remove the side cover for wire connection.

WARNING

- If you cannot attach the side cover due to the connection cord, please press the connecting cord in the direction to the front panel to fix it.
- Be sure that the hooks of the side cover is fixed in certainly. Otherwise water leakage may occur and this causes short circuit or faults.
- The connecting cord should not touch to service valve and pipes. (It becomes high temperature in heating operation.)

Checking for the electric source and the voltage range

- Before installation, the power source must be checked and necessary wiring work must be completed. To make the wiring capacity proper, use the wire gauge list below for the wiring from house distribution fuse box to the outdoor unit in consideration of the locked rotor current.
- Investigate the power supply capacity and other electrical conditions at the installing location. Depending on the model of room air conditioner to be installed, request the customer to make arrangements for the necessary electrical work etc.
- The electrical work includes the wiring work up the outdoor unit. In localities where electrical conditions are poor, use of a voltage regulation is recommended.
- Install outdoor for the room air conditioner within the reaching range of the line cord.

IMPORTANT

For (Power cord - L, N, Earth)

Cable type	Wire cross-section
3 Core	2.5mm²

For (Connecting cord - 1, 2, 3, Earth)

Cable type	Wire cross-section	Cable length
4 Core	1.5mm²	up to 25m

Bind connecting cords to make them fit between the convex sections.

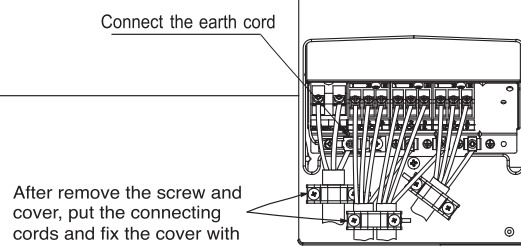
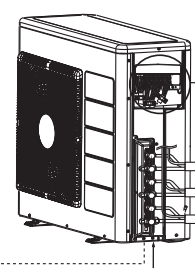

Fig. 1-3

Type of grounding rod	Length
SP-EB-2	900mm

Grounding rod (optional)

(Earth wire and grounding rod are not supplied. Please use optional items below.)

IMPORTANT

Circuit Breaker
20A

WARNING

- Connect the Connecting Cord to "Indoor 1 (1, 2, 3) for indoor unit 1, "Indoor 2 (1, 2, 3) for indoor unit 2, "Indoor 3 (1, 2, 3) for indoor 3.

CAUTION

Arrange power cord so they do not touch service valve.

CAUTION

Note:
• Outdoor supply cords shall not be lighter than polychloroprene sheathed flexible cord with code designation 60245 IEC 57.

1 Insulation And Maintenance Of Pipe Connection

- The connected terminals should be completely sealed with heat insulator and then tied up with rubber strap.
- Please tie the pipe and power line together with vinyl tape as shown in the figure showing the installation of Indoor and Outdoor units. Then fix their position with holders.
- To enhance the heat insulation and to prevent water condensation, please cover the outdoor part of the drain hose and pipe with insulation pipe.
- Completely seal any gap with putty.

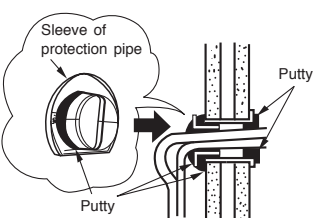
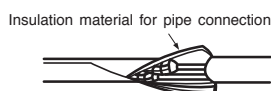

2 Power Source And Operation Test

Power Source

WARNING

- Never remodel the power plug nor extend the long-distance cord.
- Keep additional length for the power cord and do not render the plug under external force as this may cause poor contact.
- Do not fix the power cord with U-shape nail.
- The power cable easily generates heat. Do not bring the cable together with a wire or vinyl tie.

Operation Test

- Please be sure to measure the supply voltage before operation test.
- Please ensure that the air conditioner is in normal operating condition during the operation test.

- Operate with Cool Mode(in summer) or Heat Mode(in winter).
- Press Temperature Button on the remote controller to set the desired temperature to 16.0°C for Cool Mode or 32.0°C for Heating Mode.

Set the desired fan speed to " (High).

- Operate the air conditioner for 20 minutes at least and make sure that the air from the air conditioner is cool or warm.
- Press the ON/Off button on the remote controller to make sure that the air conditioner stops running.
- If the indication lamps of the indoor unit blink with sounding the buzzer during the operation test, perform a check following the procedures below.

Indication lamps blinking mode	What do check
All indication lamps blink three times repeatedly.	Make sure that the spindles of both service valves are open. (Outdoor fan might operate for near 15 minutes after the operation stop for the protection. For the reoperation at that case, do it after outdoor fan will stop.)

- Before the check and the reoperation, reset the power supply by turning off and on the circuit breaker only after:-

- waiting for at least 5 mintes; or
- pressing the Temporary Switch Button only once while the power is OFF.

CAUTION

- Don't operate for over 5 minutes with the situation that the spindle of the service valve is closed. This will cause the defect.
- Don't operate by Cool Mode or Dry Mode with the door and windows opened, (the room humidity is always above 80%) for a long period of time. Water will condense and drip down occasionally. This will wet your furniture.

- Explain to your customer the proper operation procedures as described in the user's manual.
- If the indoor unit won't operate, check the cable for correct connection.
- Turn on the lamp in the room where the indoor unit is installed and check the remote controller for normal operation.

CAUTION

- Trial run should be conducted on one unit at a time to check for incorrect wiring of connecting cord.

INSTALLATION MANUAL

airHome
MultiPro

SPLIT UNIT AIR CONDITIONER

OUTDOOR UNIT
RAM-G70N4HAE



EN INSTRUCTION MANUAL

FOR SERVICE PERSONNEL ONLY

- Carefully read through the procedures of proper installation before starting installation work.
- The sales agent should inform customers regarding the correct operation of installation.

Tools Needed For Installation Work

- (⊙) mark is tool exclusive use for R32
- ⊕ ⊖ Screwdriver ● Measuring Tape
- Knife ● Saw ● Pipe Cutter
- Hexagonal Wrench Key (⊕ ⊖ 4mm)
- Power Drill (φ 65mm ~ φ 90mm)
- Vacuum Pump ● Pliers or Wrench
- Torque Wrench ● Vacuum Pump Adaptor
- Flare Tool ● Gas Leakage Detector
- Manifold Valve ● Charge Hose
- Reamer ● File

SAFETY PRECAUTION

- Read the safety precautions carefully before operating the unit.
- The contents of this section are vital to ensure safety. Please pay special attention to the following sign.

WARNING Incorrect methods of installation may cause death or serious injury.

CAUTION Improper installation may result in serious consequence.

Be sure that the unit operates in proper condition after installation. Explain to customer the proper way of operating the unit as described in the user's guide.



Access the full version of the User Installation Manual by scanning the code.

HITACHI

WARNING

- Flare nut must use a torque wrench without fail. Tighten with the specified tightening torque. If the flare nut is tightened too much, after a long period of time, the flare nut breaks, Gas leakage, stagnation, touching fire, rarely cause ignition.
- Sharp bending of the pipe use the polyethylene rod, bend not crushed the pipe. Gas leakage from the crushed part, stagnation, touching fire, rarely cause ignition.
- Please request your sales agent or qualified technician to install your unit. Water leakage, short circuit or fire may occur if you do the installation work yourself.
- Please observe the instructions stated in the installation manual during the process of installation. Improper installation may cause water leakage, electric shock and fire.
- A brazed, welded, or mechanical connection shall be made before opening the valves to permit refrigerant to flow between the refrigerating system parts. A vacuum valve shall be provided to evacuate the interconnecting pipe and/or any uncharged refrigerating system part.
- Mechanical connectors used indoors shall comply with ISO 14903. When mechanical connectors are reused indoors, sealing parts shall be renewed. When flared joints are reused indoors, the flare part shall be re-fabricated.
- Refrigerant tubing shall be protected or enclosed to avoid damage.
- Make sure that the units are mounted at locations which are able to provide full support to the weight of the units. If not, the units may collapse and impose danger.
- Observe the rules and regulations of the electrical installation and the methods described in the installation manual when dealing with the electrical work. Use power cables approved by the authorities of your country.
- Be sure to use the specified wire for connecting the indoor and outdoor units. Please ensure that the connections are tight after the conductors of the wire are inserted into the terminals. Improper insertion and loose contact may cause over-heating and fire.
- Please use the specified components for installation work. Otherwise, the units may collapse or water leakage, electric shock and fire may occur.
- Be sure to use the specified piping set for R32. Otherwise, this may result in broken copper pipes or faults.
- When installing or removing an air conditioner, only specified refrigerant (R32) shall be allowed, do not allow air or moisture to remain in the refrigeration cycle. Otherwise, pressure in the refrigeration cycle may become abnormally high so that a rupture may be caused.
- Be sure to ventilate fully if a refrigerant gas leak while at work. If the refrigerant gas comes into contact with fire, a poisonous gas may occur. Be aware that refrigerants may not contain an odour.
- After completion of installation work, check to make sure that there is no refrigeration gas leakage. If the refrigerant gas leaks into the room, coming into contact with fire in the fan-driven heater, space heater, etc., a poisonous gas may occur.
- Unauthorized modifications to the air conditioner may be dangerous. If a breakdown occurs please call a qualified air conditioner technician or electrician. Improper repairs may result in water leakage, electric shock and fire, etc.

The Choice of Mounting Site (Please note the following matters and obtain permission from customer before installation).

WARNING

- The Outdoor unit must be mounted at a location which can support heavy weight. Otherwise, noise and vibration will increase.

CAUTION

- Do not expose the unit under direct sunshine or rain. Besides, ventilation must be good and clear of obstruction.
- The air blown out of the unit should not point directly to animals or plants.
- The clearances of the unit from top, left, right and front are specified in figure below. At least 3 of the above sides must be open air.
- Be sure that the hot air blown out of the unit and noise do not disturb the neighbourhood.
- Do not install at a location where there is flammable gas, steam, oil and smoke.
- The location must be convenient for water drainage.
- Place the Outdoor unit and its connecting cord at least 1m away from the antenna or signal line of television, radio or telephone. This is to avoid noise interference.
- Do not install outdoor unit facing strong wind direction. It may damage the fan motor.
- Do not install the outdoor unit in a place where small animals may build their nests. If small animal goes inside the unit and touches the electrical parts, failure of the unit, smoke or fire may be caused. Request your customer to keep the surrounding of the unit is clean.

Names of Outdoor Components

No.	Item	Qty	Dimension of Mounting Stand of the Outdoor unit (unit : mm)
①	Bush	3	
②	Drain Pipe	1	
③	Bush	1	

Figure showing the Installation of Outdoor Unit.

CAUTION

- This unit is chargeless up 30m pipe length.
- Installation of pipe length less than minimum pipe length requirement (3 meters) may generate an abnormal sound.

Table 1: Minimum Floor area of the room A_{min} (m²)

Outdoor Model	Piping Length (m)	Max refrigerant charge amount (kg)	Minimum Floor Area of the room A _{min} (m ²)				
			Wall-mounted units	Ceiling cassette-mounted units		Floor-standing units	
				Duct-mounted units		*With SPX-RAFGLS	Without SPX-RAFGLS
RAM-G70N4HAE	Standard	30	3.97	2.66	2.66	3.00	35.77
	Maximum	60	6.64	4.45	4.45	3.88	59.77

* Gas leak sensor be setting as optional parts (SPX-RAFGLS)

WARNING

This symbol shows that this equipment uses a flammable refrigerant.
If the refrigerant is leaked, together with an external ignition source, there is a possibility of ignition.

CAUTION

This symbol shows that the Operation Instructions should be read carefully.

CAUTION

This symbol shows that a service personnel should be handling this equipment with reference to the Installation Manual.

CAUTION

This symbol shows that there is information included in the Operation Manual and/or Installation Manual

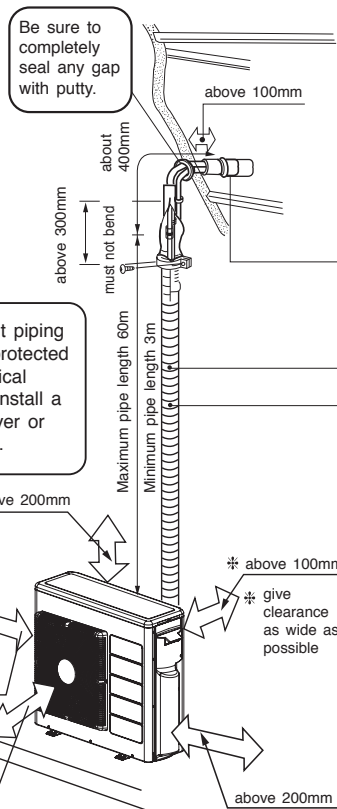

WARNING

Flare connection only at outside of building

The indoor piping should be insulated with the enclosed insulation pipe. (If the insulator is insufficient, please use commercial products).

- The difference in height between the indoor and outdoor unit should be kept max 20m.
- The connecting pipe, no matter big or small, should all be insulated with insulation pipe and then wrapped with vinyl tape. (The insulator will deteriorate if it is not wrapped with tape).

The connection of insulated drain hose.
inner diameter φ 16mm

Please use insulated drain hose for the indoor piping (commercial product).

CAUTION

- A circuit breaker or fuse must be installed. Without a circuit breaker or fuse the danger of electric shock exists. The external switch shall be incorporated to completely disconnect from power supply. It should disconnect all poles, and a contact separation of at least 3mm must be present.
- Do not install the unit near a location where there is flammable gas. The outdoor unit may catch fire if flammable gas leaks around it.
- Do not install the indoor unit in a machine shop or kitchen where vapor from oil or its mist flows to the indoor unit. The oil will deposit on the heat exchanger, thereby reducing the indoor unit performance and may deform and in the worst case, break the plastic parts of the indoor unit.
- Please ensure smooth flow of water when installing the drain hose.
- Piping shall be suitable supported with a maximum spacing of 1m between the supports.

WARNING

- Do not use means to accelerate the defrosting process or to clean, other than those recommended by the manufacturer. Any unfit method or using incompatible material may cause product damage, burst and serious injury.
- The appliance/pipe-work shall be stored in a well ventilated room with indoor floor area larger than A_{min} [refer to Table 1] and without any continuously operating ignition source. Keep away from open flames, any operating gas appliances or any operating electric heater. Else, it may explode and cause injury or death.
- The appliance/pipe-work shall be installed, and/or operated in a room with floor area larger than A_{min} [refer to Table 1] and keep away from ignition sources, such as heat/spark/open flame or hazardous areas such as gas appliances, gas cooking, reticulated gas supply systems or electric cooking appliances, etc.
- Do not pierce or burn as the appliance/pipe-work is pressurized. Do not expose the appliance/pipe-work to heat, flame, sparks, or other sources of ignition. Else, it may explode and cause injury or death.

1. Proper place for installation

1.1 Outdoor unit

- (1) Keep the space around the unit for maintenance and avoiding the effects of hindrance for normal ventilation of the unit.
- (2) The northern or eastern side of the building is better to install. At the installation on the southern or western side unavoidably, some blind should be set up for the unit. (In this case, the blind must not obstruct the ventilation of the unit.)
- (3) You'd better not put the unit at a place where is full of dirt and at a place where is wet in the rain.
- (4) Place as near as possible to the indoor unit.
- (5) Install the unit in a stable place to minimize vibration or noise.
- (6) After arranging the cords and pipes, secure them in place.

WARNING

- This appliance must be earthed.
- Power is supplied through outdoor unit, do not connect power source to indoor unit.

2. In the electrical installation a separator with a contact gap of more than 3mm has to be installed. During cleaning or service the set has to be switched off with this separator.

<IA2333: A>

CAUTION

- Make sure to connect to two or more indoor units.

Flare adaptor for piping

The flare adaptor for piping is required depending on combination of indoor units.

- φ9.52 (3/8") → φ 12.7 (1/2")
Parts number TA261D-4 001
- φ12.7 (1/2") → φ 9.52 (3/8")
Parts number TA261D-6 002
- φ12.7 (1/2") → φ 15.88 (5/8")
Parts number TA261D-6 003

- Please mount the Outdoor unit on stable ground to prevent vibration and increase of noise level.
- Decide the location for piping after sorting out the different types of pipe available.
- When removing side cover, please pull the handle after undoing the hook by pulling it downward.

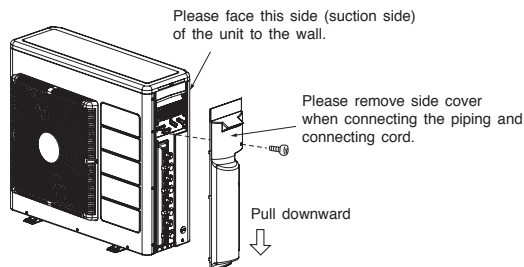

CONDENSED WATER DISPOSAL OF OUTDOOR UNIT

- There are holes on the base of Outdoor unit for condensed water to exhaust.
- In order to flow condensed water to the drain, the unit is installed on a stand or a block so that the unit is 100mm above the ground as shown figure. Join the drain pipe to one hole.
- At first insert one portion of the hook to the base (Portion A), then pull the drain pipe in the direction shown by the arrow while inserting the hook into the base. After installation, check whether the drain pipe cling to the base firmly.

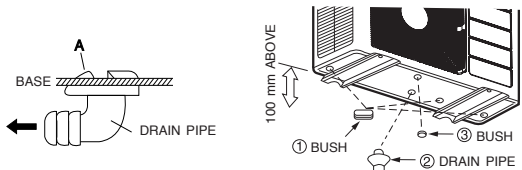

When Using and Installing In Cold Areas

When the air conditioner is used in low temperature and in snowy conditions, water from the heat exchanger may freeze on the base surface to cause poor drainage. When using the air conditioner in such areas, do not install the bushings. Keep a minimum of 250mm between the drain hole and the ground. When using the drain pipe, consult your sales agent.

※ For more details, refer to the installation Manual for Cold Areas.

1 Preparation of Pipe

- Use a pipe cutter to cut the copper pipe.

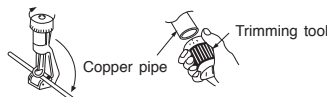

CAUTION

- Jagged edge will cause leakage.
- Point the side to be trimmed downwards during trimming to prevent copper chips from entering the pipe.

- Before flaring, please put on the flare nut.



Outer Diameter mm (inch)	Thickness (mm)	A (mm)		
		Flare tool for R32 Clutch type	Conventional flare tool Clutch type	Wing nut type
6.35 (1/4")	0.8	0.0 ~ 0.5	1.0 ~ 1.5	1.5 ~ 2.0
9.52 (3/8")	0.8	0.0 ~ 0.5	1.0 ~ 1.5	1.5 ~ 2.0
12.70 (1/2")	0.8	0.0 ~ 0.5	1.0 ~ 1.5	1.5 ~ 2.5
15.88 (5/8")	1.0	0.0 ~ 0.5	1.0 ~ 1.5	1.5 ~ 2.5

2 Pipe Connection

CAUTION

In case of removing flare nut of an Indoor unit, first remove a nut of small diameter side, or a seal cap of big diameter side will fly out. Prevent water from entering into the piping when working.

		Outer dia. of pipe	Torque N·m (kgf·cm)
Small dia. side	Valve head cap	6.35 (1/4")	14.0 ~ 18.0 (140 ~ 180)
	Spindle	9.52 (3/8")	33.0 ~ 42.0 (330 ~ 420)
Large dia. side	Valve head cap	12.70 (1/2")	50.0 ~ 62.0 (500 ~ 620)
	Spindle	15.87 (5/8")	98.0~10.78 (100~110)

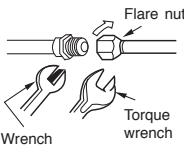

3 Removal Of Air From The Pipe And Gas Leakage Inspection

Procedures of using Vacuum Pump for Air Removal

- As shown in right figure, remove the cap of valve core. Then, connect the charge hose. Remove the cap of valve head. Connect the vacuum pump adapter to the vacuum pump and connect the charge hose to the adapter.

- Fully tighten the "Hi" knob of the manifold valve and completely unscrew the "Lo" knob. Run the vacuum pump for about 10~15 minutes, then completely tighten the "Lo" knob and switch off the vacuum pump.

- Remove the charge hose and tighten the cap of valve core. Check the cap's periphery if there is any gas leakage.

- Completely unscrew the spindle of the service valve in anti-clockwise direction to allow the flow of refrigerant (using Hexagonal Wrench key).

- Re-cap the service valve and tighten using wrench. Check the cap's periphery if there is any gas leakage. The task is then completed.

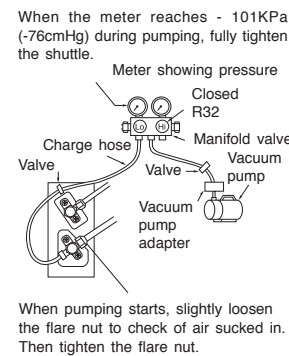

When the meter reaches - 101KPa (-76cmHg) during pumping, fully tighten the shuttle.

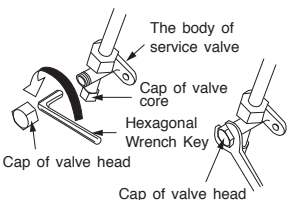

Gas Leakage Inspection

Please use gas leakage detector to check if leakage occurs at the connection of Flare nut as shown on the right.

If gas leakage occurs, further tighten the connection to stop leakage. (Be sure to use R32 detector)

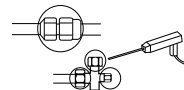

WARNING • THIS APPLIANCE MUST BE EARTHED.

Procedures of Wiring

- Installation procedure and notice
Especially, the selection of installation place need great care for the split type air conditioner, because it is very difficult to move from place to place after the first installation.

1.1 Wiring

- Connect the electrical wiring between the Indoor and Outdoor unit, as shown in Fig. 1-1. Never connect the wiring by mistake. In case of wrong connection, the unit does not operate properly and it may cause malfunction.
- The connecting cord must be fixed by the band which is located near the terminal board.

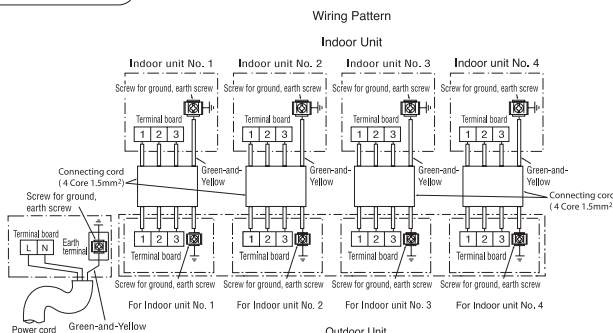

Fig. 1-1

1.2 Connection of the connecting cords and power cord

- Cut off the connecting cord, the power cord and strip the insulation of the wire, as shown in Fig. 1-2.
- Connect the connecting cord and power cord to the terminal board. (Fig. 1-3)
- Fix the connecting cords and power cord with steel band certainly. (Fig. 1-3)

Detail of Cutting the Connecting Cord

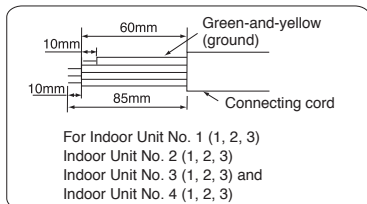
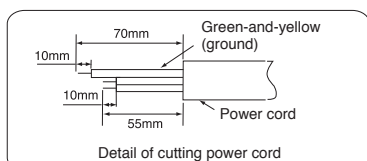
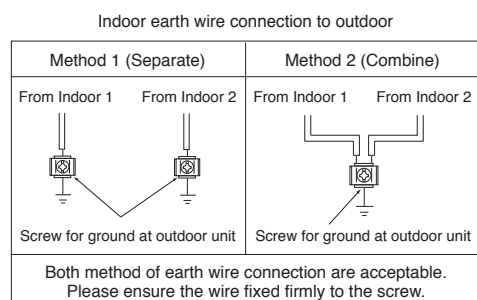

Fig. 1-2



WARNING

- Leave some space in the connecting cord for maintenance purpose and be sure to secure it with the cord band.
- Secure the connecting cord along the coated part of the wire using the cord band. Do not exert pressure on the wire as this may cause overheating or fire.

WARNING

- The naked part of the wire core should be 10 mm and fix it to the terminal tightly. Then try to pull the individual wire to check if the contact is tight. Improper insertion may burn the terminal.
- Be sure to use only wire specified for the use of air-conditioner.
- Please refer to the manual for wire connection and the wiring technique should meet the standard of the electrical installation.
- There is an AC voltage drop between the LN terminal if the power is on. Therefore, be sure to remove the plug from its socket.

Wiring of The Outdoor Unit

- Please remove the side cover for wire connection.

WARNING

- If you cannot attach the side cover due to the connection cord, please press the connecting cord in the direction to the front panel to fix it.
- Be sure that the hooks of the side cover is fixed in certainly. Otherwise water leakage may occur and this causes short circuit or faults.
- The connecting cord should not touch to service valve and pipes. (It becomes high temperature in heating operation.)

Checking for the electric source and the voltage range

- Before installation, the power source must be checked and necessary wiring work must be completed. To make the wiring capacity proper, use the wire gauge list below for the wiring from house distribution fuse box to the outdoor unit in consideration of the locked rotor current.
- Investigate the power supply capacity and other electrical conditions at the installing location. Depending on the model of room air conditioner to be installed, request the customer to make arrangements for the necessary electrical work etc. The electrical work includes the wiring work up the outdoor unit. In localities where electrical conditions are poor, use of a voltage regulation is recommended.
- Install outdoor for the room air conditioner within the reaching range of the line cord.

IMPORTANT

For (Power cord - L, N, Earth)

Cable type	Wire cross-section
3 Core	2.5mm ²

For (Connecting cord - 1, 2, 3, Earth)

Cable type	Wire cross-section	Cable length
4 Core	1.5mm ²	up to 25m

Bind connecting cords to make them fit between the convex sections.

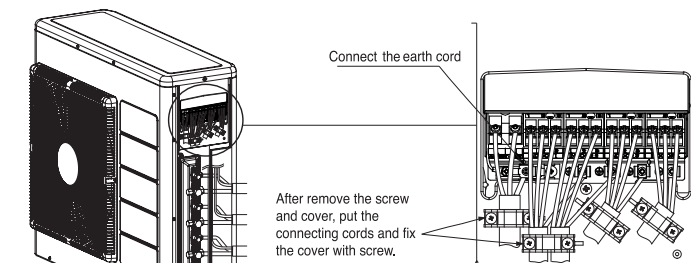

Fig. 1-3

Type of grounding rod	Length
SP-EB-2	900mm

Grounding rod (optional)
(Earth wire and grounding rod are not supplied. Please use optional items below.)

IMPORTANT

Circuit Breaker
20A

CAUTION

Arrange power cord so they do not touch service valve.

CAUTION

Note:
• Outdoor supply cords shall not be lighter than polychloroprene sheathed flexible cord with code designation 60245 IEC 57.

1 Insulation And Maintenance Of Pipe Connection

- The connected terminals should be completely sealed with heat insulator and then tied up with rubber strap.
- Please tie the pipe and power line together with vinyl tape as shown in the figure showing the installation of Indoor and Outdoor units. Then fix their position with holders.
- To enhance the heat insulation and to prevent water condensation, please cover the outdoor part of the drain hose and pipe with insulation pipe.
- Completely seal any gap with putty.

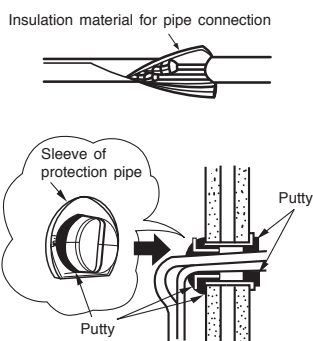

2 Power Source And Operation Test

Power Source

WARNING

- Never remodel the power plug nor extend the long-distance cord.
- Keep additional length for the power cord and do not render the plug under external force as this may cause poor contact.
- Do not fix the power cord with U-shape nail.
- The power cable easily generates heat. Do not bring the cable together with a wire or vinyl tie.

Operation Test

- Please be sure to measure the supply voltage before operation test.
- Please ensure that the air conditioner is in normal operating condition during the operation test.

- Operate with Cool Mode(in summer) or Heat Mode(in winter).
- Press Temperature Button on the remote controller to set the desired temperature to 16.0°C for Cool Mode or 32.0°C for Heating Mode.

Set the desired fan speed to " (High)."

- Operate the air conditioner for 20 minutes at least and make sure that the air from the air conditioner is cool or warm.
- Press the ON/Off button on the remote controller to make sure that the air conditioner stops running.
- If the indication lamps of the indoor unit blink with sounding the buzzer during the operation test, perform a check following the procedures below.

Indication lamps blinking mode	What do check
All indication lamps blink three times repeatedly.	Make sure that the spindles of both service valves are open. (Outdoor fan might operate for near 15 minutes after the operation stop for the protection. For the reoperation at that case, do it after outdoor fan will stop.)

- Before the check and the reoperation, reset the power supply by turning off and on the circuit breaker only after:-

- waiting for at least 5 minutes; or
- pressing the Temporary Switch Button only once while the power is OFF.

CAUTION

- Don't operate for over 5 minutes with the situation that the spindle of the service valve is closed. This will cause the defect.
- Don't operate by Cool Mode or Dry Mode with the door and windows opened, (the room humidity is always above 80%) for a long period of time. Water will condense and drip down occasionally. This will wet your furniture.

- Explain to your customer the proper operation procedures as described in the user's manual.
- If the indoor unit won't operate, check the cable for correct connection.
- Turn on the lamp in the room where the indoor unit is installed and check the remote controller for normal operation.

CAUTION

- Trial run should be conducted on one unit at a time to check for incorrect wiring of connecting cord.

INSTALLATION MANUAL

airHome
MultiPro

SPLIT UNIT AIR CONDITIONER

OUTDOOR UNIT
RAM-G85N5HAE



EN INSTRUCTION MANUAL

FOR SERVICE PERSONNEL ONLY

- Carefully read through the procedures of proper installation before starting installation work.
- The sales agent should inform customers regarding the correct operation of installation.

Tools Needed For Installation Work

- (⊙) mark is tool exclusive use for R32)
- ⊕ ⊖ Screwdriver ● Measuring Tape
- Knife ● Saw ● Pipe Cutter
- Hexagonal Wrench Key (⊕ ⊖ 4mm)
- Power Drill (φ 65mm ~ φ 90mm)
- Vacuum Pump ● Pliers or Wrench
- Torque Wrench ● Vacuum Pump Adaptor
- Flare Tool ● Gas Leakage Detector
- Manifold Valve ● Charge Hose
- Reamer ● File

SAFETY PRECAUTION

- Read the safety precautions carefully before operating the unit.
- The contents of this section are vital to ensure safety. Please pay special attention to the following sign.

WARNING Incorrect methods of installation may cause death or serious injury.

CAUTION Improper installation may result in serious consequence.

Be sure that the unit operates in proper condition after installation. Explain to customer the proper way of operating the unit as described in the user's guide.



Access the full version of the User Installation Manual by scanning the code.

HITACHI

WARNING

- Flare nut must use a torque wrench without fail. Tighten with the specified tightening torque. If the flare nut is tightened too much, after a long period of time, the flare nut breaks, Gas leakage, stagnation, touching fire, rarely cause ignition.
- Sharp bending of the pipe use the polyethylene rod, bend not crushed the pipe. Gas leakage from the crushed part, stagnation, touching fire, rarely cause ignition.
- Please request your sales agent or qualified technician to install your unit. Water leakage, short circuit or fire may occur if you do the installation work yourself.
- Please observe the instructions stated in the installation manual during the process of installation. Improper installation may cause water leakage, electric shock and fire.
- A brazed, welded, or mechanical connection shall be made before opening the valves to permit refrigerant to flow between the refrigerating system parts. A vacuum valve shall be provided to evacuate the interconnecting pipe and/or any uncharged refrigerating system part.
- Mechanical connectors used indoors shall comply with ISO 14903. When mechanical connectors are reused indoors, sealing parts shall be renewed. When flared joints are reused indoors, the flare part shall be re-fabricated.
- Refrigerant tubing shall be protected or enclosed to avoid damage.
- Make sure that the units are mounted at locations which are able to provide full support to the weight of the units. If not, the units may collapse and impose danger.
- Observe the rules and regulations of the electrical installation and the methods described in the installation manual when dealing with the electrical work. Use power cables approved by the authorities of your country.
- Be sure to use the specified wire for connecting the indoor and outdoor units. Please ensure that the connections are tight after the conductors of the wire are inserted into the terminals. Improper insertion and loose contact may cause over-heating and fire.
- Please use the specified components for installation work. Otherwise, the units may collapse or water leakage, electric shock and fire may occur.
- Be sure to use the specified piping set for R32. Otherwise, this may result in broken copper pipes or faults.
- When installing or removing an air conditioner, only specified refrigerant (R32) shall be allowed, do not allow air or moisture to remain in the refrigeration cycle. Otherwise, pressure in the refrigeration cycle may become abnormally high so that a rupture may be caused.
- Be sure to ventilate fully if a refrigerant gas leak while at work. If the refrigerant gas comes into contact with fire, a poisonous gas may occur. Be aware that refrigerants may not contain an odour.
- After completion of installation work, check to make sure that there is no refrigeration gas leakage. If the refrigerant gas leaks into the room, coming into contact with fire in the fan-driven heater, space heater, etc., a poisonous gas may occur.
- Unauthorized modifications to the air conditioner may be dangerous. If a breakdown occurs please call a qualified air conditioner technician or electrician. Improper repairs may result in water leakage, electric shock and fire, etc.

The Choice of Mounting Site (Please note the following matters and obtain permission from customer before installation).

WARNING

- The Outdoor unit must be mounted at a location which can support heavy weight. Otherwise, noise and vibration will increase.

CAUTION

- Do not expose the unit under direct sunshine or rain. Besides, ventilation must be good and clear of obstruction.
- The air blown out of the unit should not point directly to animals or plants.
- The clearances of the unit from top, left, right and front are specified in figure below. At least 3 of the above sides must be open air.
- Be sure that the hot air blown out of the unit and noise do not disturb the neighbourhood.
- Do not install at a location where there is flammable gas, steam, oil and smoke.
- The location must be convenient for water drainage.
- Place the Outdoor unit and its connecting cord at least 1m away from the antenna or signal line of television, radio or telephone. This is to avoid noise interference.
- Do not install outdoor unit facing strong wind direction. It may damage the fan motor.
- Do not install the outdoor unit in a place where small animals may build their nests. If small animal goes inside the unit and touches the electrical parts, failure of the unit, smoke or fire may be caused. Request your customer to keep the surrounding of the unit is clean.

Names of Outdoor Components

No.	Item	Qty
⑩	Bush	3
⑪	Drain Pipe	1

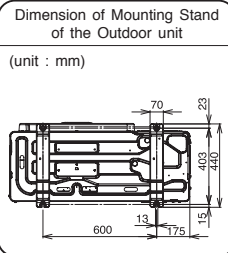

Figure showing the Installation of Outdoor Unit.

CAUTION

- This unit is chargeless up 35m pipe length.
- Installation of pipe length less than minimum pipe length requirement (3 meters) may generate an abnormal sound.

Table 1: Minimum Floor area of the room A_{min} (m²)

Outdoor Model	Piping Length (m)	Max refrigerant charge amount (kg)	Minimum Floor Area of the room A _{min} (m ²)					
			Wall-mounted units	Ceiling cassette-mounted units		Floor-standing units		
				Duct-mounted units		*With SPX-RAFGLS	Without SPX-RAFGLS	
RAM-G85N5HAE	Standard	35	5.45	3.65	3.65	3.51	49.02	
	Maximum	75	8.51	5.7	5.7	4.39	76.60	

* Gas leak sensor be setting as optional parts (SPX-RAFGLS)

WARNING

This symbol shows that this equipment uses a flammable refrigerant. If the refrigerant is leaked, together with an external ignition source, there is a possibility of ignition.

CAUTION

This symbol shows that the Operation Instructions should be read carefully.

CAUTION

This symbol shows that a service personnel should be handling this equipment with reference to the Installation Manual.

CAUTION

This symbol shows that there is information included in the Operation Manual and/or Installation Manual

WARNING

BURST HAZARD
Do not allow air, etc. to get into refrigerant cycle (piping)

RISK OF EXPLOSION
Compressor must be stopped before removing refrigerant pipes. All service valve must be fully closed after pumping down operation.

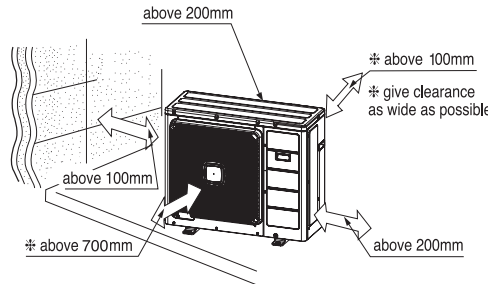

Height difference

Height difference between indoor units should not be more than 5m.

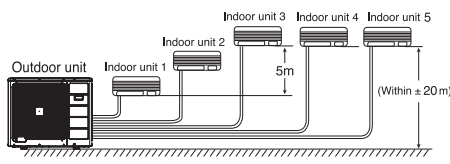

Piping length

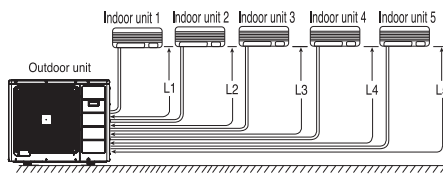

(L1 + L2 + L3 + L4 + L5) = Maximum 75m

Minimum piping length for each indoor unit is 3m. Maximum piping length for one indoor unit is 25m.

- ※ In case the pipe length is more than 35m, add refrigerant R32 at 15 gram per every meter exceeds
- ※ In case of only 2 indoor units connected, minimum pipe length is 13m for each unit.

[Outdoor unit installation]

- Mount the Outdoor unit on stable ground to prevent vibration and increase of noise level.
- Decide the location for piping after sorting out the different types of pipe available.
- When removing side plate, pull the handle after releasing the hook by pulling it downward.

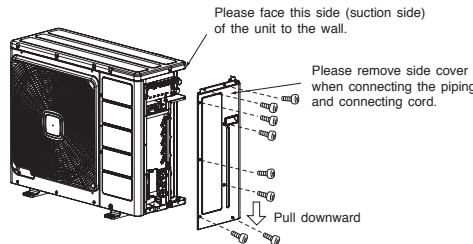

CONDENSED WATER DISPOSAL OF OUTDOOR UNIT

- There are holes on the base of Outdoor unit for condensed water to exhaust.
- In order to flow condensed water to the drain, the unit is installed on a stand or a block so that the unit is 100mm above the ground as shown figure. Join the drain pipe to one hole.
- At first insert one portion of the hook to the base (Portion A), then pull the drain pipe in the direction shown by the arrow while inserting the hook into the base. After installation, check whether the drain pipe cling to the base firmly.

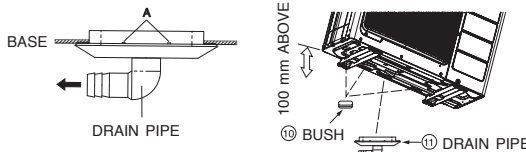

When Using and Installing In Cold Areas

When the air conditioner is used in low temperature and in snowy conditions, water from the heat exchanger may freeze on the base surface to cause poor drainage. When using the air conditioner in such areas, do not install the bushings. Keep a minimum of 250mm between the drain hole and the ground. When using the drain pipe, consult your sales agent.

※ For more details, refer to the installation Manual for Cold Areas.

CAUTION

- Make sure to connect to two or more indoor units.

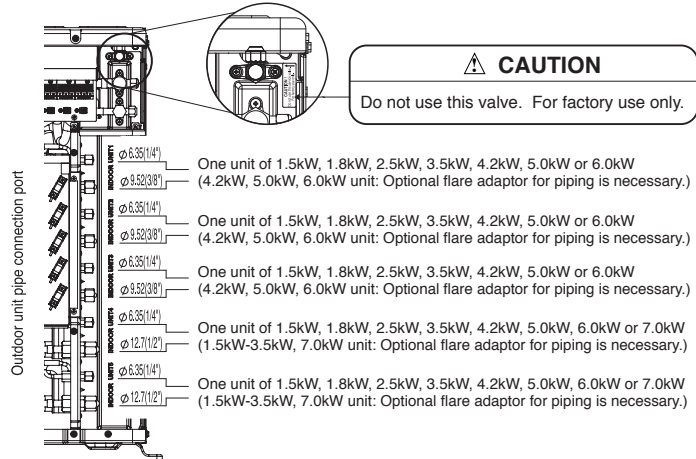

CAUTION

Do not use this valve. For factory use only.

Flare adaptor for piping

The flare adaptor for piping is required depending on combination of indoor units.

- ø9.52 (3/8") → ø 12.7 (1/2") Parts number TA261D-4-001
- ø12.7 (1/2") → ø 9.52 (3/8") Parts number TA261D-6-002
- ø12.7 (1/2") → ø 15.88 (5/8") Parts number TA261D-6-003

- To the outdoor unit, up to five indoor units can be connected until the total value of each units's capacity reaches 15.5 kW.
- The pipe connection ports of the outdoor unit and connectable indoor units are shown above.

Cooling & Heating

<IA2339: A>

1 Preparation of Pipe

- Use a pipe cutter to cut the copper pipe.

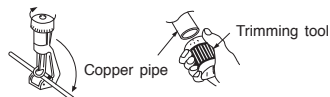

CAUTION

- Jagged edge will cause leakage.
- Point the side to be trimmed downwards during trimming to prevent copper chips from entering the pipe.

- Before flaring, please put on the flare nut.

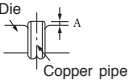
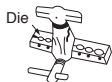

- Recommend to use R32 flaring tool.

Outer Diameter mm (inch)	Thickness (mm)	A (mm)		
		Flare tool for R32 Clutch type	Conventional flare tool Clutch type Wing nut type	
6.35 (1/4")	0.8	0.0 ~ 0.5	1.0 ~ 1.5	1.5 ~ 2.0
9.52 (3/8")	0.8	0.0 ~ 0.5	1.0 ~ 1.5	1.5 ~ 2.0
12.70 (1/2")	0.8	0.0 ~ 0.5	1.0 ~ 1.5	1.5 ~ 2.5
15.88 (5/8")	1.0	0.0 ~ 0.5	1.0 ~ 1.5	1.5 ~ 2.5

2 Pipe Connection

CAUTION

In case of removing flare nut of an Indoor unit, first remove a nut of small diameter side, or a seal cap of big diameter side will fly out. Prevent water from entering into the piping when working.

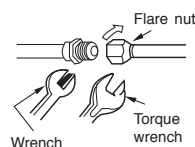

		Outer dia. of pipe	Torque N·m (kgf·cm)
Small dia. side		6.35 (1/4")	14.0 ~ 18.0 (140 ~ 180)
Large dia. side		9.52 (3/8") 12.70 (1/2")	33.0 ~ 42.0 (330 ~ 420) 50.0 ~ 62.0 (500 ~ 620)
Valve head cap	Small dia. side	6.35 (1/4")	19.6 ~ 24.5 (200 ~ 250)
	Large dia. side	9.52 (3/8") 12.7 (1/2")	19.6 ~ 24.5 (200 ~ 250) 29.4 ~ 34.3 (300 ~ 350)
Valve core cap			12.3 ~ 15.7 (125 ~ 160)
Spindle	Small dia. side	6.35 (1/4") 9.52 (3/8")	3.92~5.88 (40~60)
	Large dia. side	12.7 (1/2") 15.87 (5/8")	9.80~10.78 (100~110)

3 Removal Of Air From The Pipe And Gas Leakage Inspection

This system integrates 5 sub-systems of piping with 1 pair of service valves installed. That pair will be used for air purging and pumping down operations. Furthermore, due to valves are not installed to cover up the connecting mouths, there is a need for all unutilized connecting mouths to be tightly covered up by seal caps and flared nuts.

CAUTION: Should all unutilized connecting mouths are not tightly covered up by seal caps and flared nuts, there will be potential gas leaks occurring.

1. Air purging by using vacuum pump

Remove the valve cap from the service valves located at both the large and small pipe rims.

After removing the valve cap of the valve core of the service valves located at the large pipe rim, connect the charging hose A.

After connecting the vacuum suction pump adaptor, connect the charging hose B to the adaptor.

During relocation or at any one time when the air conditioner unit is removed and re-installed, there is a possibility of getting a closed electric-powered valve. Should the electric-powered valve be closed, even with air purging being conducted, certain amount of air is still trapped within that area, hence, there is a need to open up the electric-powered valve to do an air purging. Under such circumstances, before using the vacuum-suction pump, the main power supply (LN terminal) should be connected to enable a complete opening up of the valve. After connecting the power supply for approximately 90 seconds, the valve will be fully opened up, after which disconnect the power supply and start using the vacuum suction pump.

(Refer to "Power Supply Terminal Connections" in regards to the LN terminal)

CAUTION: Ingress of air during the operating cycle may cause increase in pressure and other breakdowns.

Switch off the outdoor unit's power supply

Shutting off via the manifold valve handle Hi, the handle Lo will open up and operate the vacuum pump that will run a vacuum suction for approximately 60 minutes.

Upon a full shut off via the manifold valve handle Lo, the vacuum pump will stop operating.

Check to ensure that there is no gas leakage.

After removing the charging hose A, rotate the service valve spindles (2 units on both sides) in an anti-clockwise direction to fully open up.

Reinstall the cap nuts to their original positions and tighten them to their specified torque values.

Disconnect the charge hose from the service valve.

Tighten the valve cap of valve core.
[Torque 12.3 - 15.7 N·m (125 - 160 kgf·cm)]

Attach the valve cap to the spindles of each large and small dia. pipe side service valves.

Tighten the valve cap of the spindle.

[Torque 19.6 - 24.5 N·m (200 - 250 kgf·cm)]

Air purging by vacuum pump

When the meter reaches -101KPa (-76cmHg) during pumping, fully tighten the shuttle.

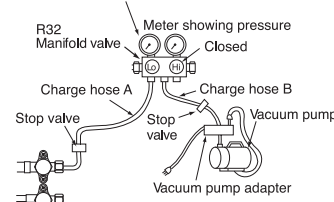

Be sure the stop valve is always fully opened.

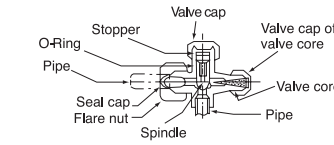

(The refrigerant channel is opened so that the refrigerant will flow from the outdoor unit into the indoor unit.)

CAUTION

- Prevent moisture from entering pipe connection.
- Refrigerating machine oil not be applied to the outside of the flare.
- When refrigerating machine oil is applied to the outside of the flare, excessive tightening of the flare nut, cracking of the flare nut, destruction of the flare and gas leakage may occur.
- When using the control valve, do not use deteriorated packing. And, do not overtighten the steering wheel.
- Gas leakage from the service valve part, stagnation, touching fire, rarely cause ignition.

Gas Leakage Inspection

Please use gas leakage detector to check if leakage occurs at the connection of Flare nut as shown on the right.

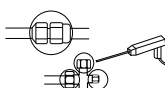

If gas leakage occurs, further tighten the connection to stop leakage. (Be sure to use R32 detector)

WARNING • THIS APPLIANCE MUST BE EARTHED.

Procedures of Wiring

1. Installation procedure and notice

Especially, the selection of installation place need great care for the split type air conditioner, because it is very difficult to move from place to place after the first installation.

1.1 Wiring

- Those terminal blocks for connecting the indoor and outdoor cables should be installed starting from the righthand side, in a sequence of 1, 2, 3, 4, 5; in accordance with the units' numbering system, as illustrated in the diagram. The left hand-most terminal block is for the power supply connection use.
- Connect the electrical wiring between the Indoor and Outdoor unit, as shown in Fig. 1-1. Never connect the wiring by mistake. In case of wrong connection, the unit does not operate properly and it may cause malfunction.
- The connecting cord must be fixed by the band which is located near the terminal board.

1.2 Connection of the connecting cords and power cord

- Cut off the connecting cord, the power cord and strip the insulation of the wire, as shown in Fig. 1-2.
- Connect the connecting cord and power cord to the terminal board. (Fig. 1-3-2)
- Fix the connecting cords and power cord with steel band certainly. (Fig. 1-3-2)

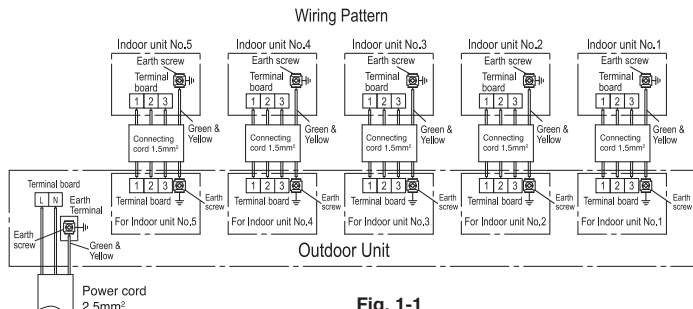

Fig. 1-1

Detail of Cutting the Connecting Cord

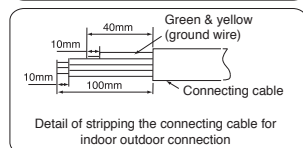
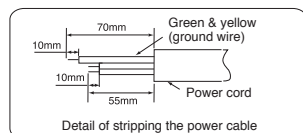

Fig. 1-2

WARNING

- Leave some space in the connecting cord for maintenance purpose and be sure to secure it with the cord band.
- Secure the connecting cord along the coated part of the wire using the cord band. Do not exert pressure on the wire as this may cause overheating or fire.

Wiring of The Outdoor Unit

- Please remove the side cover for wire connection.

WARNING

- If you cannot attach the side cover due to the connecting cord, press the connecting cord in direction to the front panel to fix it.
- Be sure that the hooks of the side cover is fixed in certainly. Otherwise water leakage may occur and this causes short circuit or faults.
- The connecting cord should not touch to service valve and pipes. (It becomes high temperature in heating operation.)

Checking for the electric source and the voltage range

- Before installation, the power source must be checked and necessary wiring work must be completed. To make the wiring capacity proper, use the wire gauges list below for the lead-in from a pole transformer and for the wiring from a switch board of fuse box to the main switch and outdoor unit in consideration of the locked rotor current.
- Do not connect wrongly at terminal "1 2 3" of indoor and outdoor unit.
- To avoid misconnection, please refer attached terminal label as shown in Fig. 1-3-1.
- To avoid connecting cord scratch or clamp by side cover, it must be fix by band as shown in Fig. 1-3-2.

IMPORTANT

Cable length	Wire cross-section
up to 25m	2.5mm²

Bind connecting cords to make them fit between the convex sections.

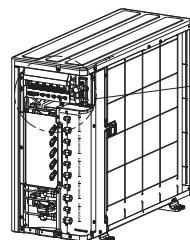

Fig. 1-3-1

Connect the power supply earth cord at this earth screw.

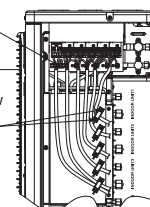

Fig. 1-3-2

Grounding rod (optional)
(Earth wire and grounding rod are not supplied. Please use optional items below.)

Type of grounding rod	Length
SP-EB-2	900mm

- Investigate the power supply capacity and other electrical conditions at the installation location. Depending on the model of room air conditioner to be installed, request the customer to make arrangements for the necessary electrical work etc. The electrical work includes the wiring work up the outlet. In localities where electrical conditions are poor, use of a voltage regulator is recommended.

IMPORTANT

Circuit Breaker
25A

CAUTION

Arrange power cord so they do not touch service valve.

CAUTION

- Note:
- Outdoor supply cords shall not be lighter than polychloroprene sheathed flexible cord with code designation 60245 IEC 57.

1 Insulation And Maintenance Of Pipe Connection

- The connected terminals should be completely sealed with heat insulator and then tied up with rubber strap.
- Please tie the pipe and power line together with vinyl tape as shown in the figure showing the installation of Indoor and Outdoor units. Then fix their position with holders.
- To enhance the heat insulation and to prevent water condensation, please cover the outdoor part of the drain hose and pipe with insulation pipe.
- Completely seal any gap with putty.

Insulation material for pipe connection

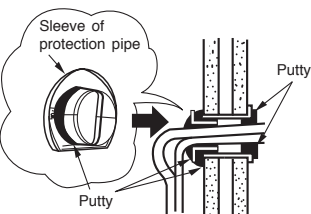

2 Power Source And Operation Test

Power Source

WARNING

- Never remodel the power plug nor extend the long-distance cord.
- Keep additional length for the power cord and do not render the plug under external force as this may cause poor contact.
- Do not fix the power cord with U-shape nail.
- The power cable easily generates heat. Do not bring the cable together with a wire or vinyl tie.

Operation Test

- Please be sure to measure the supply voltage before operation test.
- Please ensure that the air conditioner is in normal operating condition during the operation test.

- Operate with Cool Mode(in summer) or Heat Mode(in winter).
- Press Temperature Button on the remote controller to set the desired temperature to 16.0°C for Cool Mode or 32.0°C for Heating Mode.

Set the desired fan speed to " (High).

- Operate the air conditioner for 20 minutes at least and make sure that the air from the air conditioner is cool or warm.
- Press the ON/Off button on the remote controller to make sure that the air conditioner stops running.
- If the indication lamps of the indoor unit blink with sounding the buzzer during the operation test, perform a check following the procedures below.

Indication lamps blinking mode	What do check
All indication lamps blink three times repeatedly.	Make sure that the spindles of both service valves are open. (Outdoor fan might operate for near 15 minutes after the operation stop for the protection. For the reoperation at that case, do it after outdoor fan will stop.)

- Before the check and the reoperation, reset the power supply by turning off and on the circuit breaker only after:-

- waiting for at least 5 mintes; or
- pressing the Temporary Switch Button only once while the power is OFF.

CAUTION

- Don't operate for over 5 minutes with the situation that the spindle of the service valve is closed. This will cause the defect.
- Don't operate by Cool Mode or Dry Mode with the door and windows opened, (the room humidity is always above 80%) for a long period of time. Water will condense and drip down occasionally. This will wet your furniture.

- Explain to your customer the proper operation procedures as described in the user's manual.
- If the indoor unit won't operate, check the cable for correct connection.
- Turn on the lamp in the room where the indoor unit is installed and check the remote controller for normal operation.

CAUTION

- Trial run should be conducted on one unit at a time to check for incorrect wiring of connecting cord.

INSTALLATION
MANUAL

airHome

Multi Pro

SPLIT UNIT AIR CONDITIONER

OUTDOOR UNIT

RAM-G110N5HAE

R32

EN INSTRUCTION MANUAL

FOR SERVICE
PERSONNEL ONLY

Carefully read through the
procedures of proper installation
before starting installation work.
The sales agent should inform
customers regarding the correct
operation of installation.

Tools Needed For Installation Work

(● mark is tool exclusive use for R32) ● Screwdriver ● Measuring Tape ● Knife ● Saw ● Pipe Cutter
● Hexagonal Wrench Key (1 3/8 4mm) ● Power Drill (6 5mm ~ 8 80mm) ● Vacuum Pump
● Pliers or Wrench ● Torque Wrench ● Vacuum Pump Adaptor ● Flare Tool ● Gas Leakage
Detector ● Manifold Valve ● Charge Hose ● Reamer ● File

Access the full version of the
User Installation Manual by
scanning the code.

EE0021647B rev.0-09/2023

● Please request your sales agent or qualified technician to install your unit. Water leakage, short circuit or fire may occur if you do the installation work yourself.

● Please observe the installation stated in the installation manual during the process of installation. Improper installation may cause water leakage, electric shock and fire.

● Make sure that the units are mounted at locations which are able to provide full support to the weight of the units. If not, the units may collapse and impose danger.

● Observe the rules and regulations of the electrical installation and the methods described in the installation manual when dealing with the electrical work. Use cables which are approved official in your country. Be sure to use the specified circuit. A short circuit and/or fire may occur due to the use of low quality wire or improper work.

● Be sure to use the specified cables for connecting the indoor and outdoor units. Please ensure that the connections are tight after the conductors of the wire are inserted into the terminals to prevent the external force is being applied to the connection section of the terminal base. Improper insertion and loose contact may cause over-heating and fire.

● Please use the specified components for installation work. Otherwise, the unit may collapse or water leakage, electric shock, fire or stronger vibration may occur.

● Be sure to use the specified piping set for R32. Otherwise, this may result in broken copper pipes or faults.

● When installing or transferring an air conditioner to another location, make sure that air other than the specified refrigerant (R32) does not enter the refrigeration cycle. If other air should enter, the pressure level of the refrigeration cycle may increase abnormally which could result in a rupture and injury.

● Never install a drier to this R32 unit in order to guarantee its lifetime.

● Be sure to ventilate fully if a refrigerant gas leak while at work. If the refrigerant gas comes into contact with fire, a poisonous gas may occur.

● After completion of installation work, check to make sure that there is no refrigeration gas leakage. If the refrigerant gas leaks into the room, coming into contact with fire in the fan-driven heater, space heater, etc., a poisonous gas may occur.

● Unauthorized modifications to the air conditioner may be dangerous. If a breakdown occurs, please call a qualified air conditioner technician or electrician. Improper repairs may result in water leakage, electric shock and fire, etc.

● Be sure to connect the earth line from the power supply wire to the outdoor unit and between the outdoor and indoor unit. Do not connect the earth line to the gas tube, water pipe, lightning rod or the earth line of telephone unit. Improper earthing may cause electric shocks.

● Carefully read through the
procedures of proper installation
before starting installation work.
The sales agent should inform
customers regarding the correct
operation of installation.

● Please request your sales agent or qualified technician to install your unit. Water leakage, short circuit or fire may occur if you do the installation work yourself.

● Please observe the installation stated in the installation manual during the process of installation. Improper installation may cause water leakage, electric shock and fire.

● Make sure that the units are mounted at locations which are able to provide full support to the weight of the units. If not, the units may collapse and impose danger.

● Observe the rules and regulations of the electrical installation and the methods described in the installation manual when dealing with the electrical work. Use cables which are approved official in your country. Be sure to use the specified circuit. A short circuit and/or fire may occur due to the use of low quality wire or improper work.

● Be sure to use the specified cables for connecting the indoor and outdoor units. Please ensure that the connections are tight after the conductors of the wire are inserted into the terminals to prevent the external force is being applied to the connection section of the terminal base. Improper insertion and loose contact may cause over-heating and fire.

● Please use the specified components for installation work. Otherwise, the unit may collapse or water leakage, electric shock, fire or stronger vibration may occur.

● Be sure to use the specified piping set for R32. Otherwise, this may result in broken copper pipes or faults.

● When installing or transferring an air conditioner to another location, make sure that air other than the specified refrigerant (R32) does not enter the refrigeration cycle. If other air should enter, the pressure level of the refrigeration cycle may increase abnormally which could result in a rupture and injury.

● Never install a drier to this R32 unit in order to guarantee its lifetime.

● Be sure to ventilate fully if a refrigerant gas leak while at work. If the refrigerant gas comes into contact with fire, a poisonous gas may occur.

● After completion of installation work, check to make sure that there is no refrigeration gas leakage. If the refrigerant gas leaks into the room, coming into contact with fire in the fan-driven heater, space heater, etc., a poisonous gas may occur.

● Unauthorized modifications to the air conditioner may be dangerous. If a breakdown occurs, please call a qualified air conditioner technician or electrician. Improper repairs may result in water leakage, electric shock and fire, etc.

● Be sure to connect the earth line from the power supply wire to the outdoor unit and between the outdoor and indoor unit. Do not connect the earth line to the gas tube, water pipe, lightning rod or the earth line of telephone unit. Improper earthing may cause electric shocks.

● Carefully read through the
procedures of proper installation
before starting installation work.
The sales agent should inform
customers regarding the correct
operation of installation.

● Please request your sales agent or qualified technician to install your unit. Water leakage, short circuit or fire may occur if you do the installation work yourself.

● Please observe the installation stated in the installation manual during the process of installation. Improper installation may cause water leakage, electric shock and fire.

● Make sure that the units are mounted at locations which are able to provide full support to the weight of the units. If not, the units may collapse and impose danger.

● Observe the rules and regulations of the electrical installation and the methods described in the installation manual when dealing with the electrical work. Use cables which are approved official in your country. Be sure to use the specified circuit. A short circuit and/or fire may occur due to the use of low quality wire or improper work.

● Be sure to use the specified cables for connecting the indoor and outdoor units. Please ensure that the connections are tight after the conductors of the wire are inserted into the terminals to prevent the external force is being applied to the connection section of the terminal base. Improper insertion and loose contact may cause over-heating and fire.

● Please use the specified components for installation work. Otherwise, the unit may collapse or water leakage, electric shock, fire or stronger vibration may occur.

● Be sure to use the specified piping set for R32. Otherwise, this may result in broken copper pipes or faults.

● When installing or transferring an air conditioner to another location, make sure that air other than the specified refrigerant (R32) does not enter the refrigeration cycle. If other air should enter, the pressure level of the refrigeration cycle may increase abnormally which could result in a rupture and injury.

● Never install a drier to this R32 unit in order to guarantee its lifetime.

● Be sure to ventilate fully if a refrigerant gas leak while at work. If the refrigerant gas comes into contact with fire, a poisonous gas may occur.

● After completion of installation work, check to make sure that there is no refrigeration gas leakage. If the refrigerant gas leaks into the room, coming into contact with fire in the fan-driven heater, space heater, etc., a poisonous gas may occur.

● Unauthorized modifications to the air conditioner may be dangerous. If a breakdown occurs, please call a qualified air conditioner technician or electrician. Improper repairs may result in water leakage, electric shock and fire, etc.

● Be sure to connect the earth line from the power supply wire to the outdoor unit and between the outdoor and indoor unit. Do not connect the earth line to the gas tube, water pipe, lightning rod or the earth line of telephone unit. Improper earthing may cause electric shocks.

● Please request your sales agent or qualified technician to install your unit. Water leakage, short circuit or fire may occur if you do the installation work yourself.

● Please observe the installation stated in the installation manual during the process of installation. Improper installation may cause water leakage, electric shock and fire.

● Make sure that the units are mounted at locations which are able to provide full support to the weight of the units. If not, the units may collapse and impose danger.

● Observe the rules and regulations of the electrical installation and the methods described in the installation manual when dealing with the electrical work. Use cables which are approved official in your country. Be sure to use the specified circuit. A short circuit and/or fire may occur due to the use of low quality wire or improper work.

● Be sure to use the specified cables for connecting the indoor and outdoor units. Please ensure that the connections are tight after the conductors of the wire are inserted into the terminals to prevent the external force is being applied to the connection section of the terminal base. Improper insertion and loose contact may cause over-heating and fire.

● Please use the specified components for installation work. Otherwise, the unit may collapse or water leakage, electric shock, fire or stronger vibration may occur.

● Be sure to use the specified piping set for R32. Otherwise, this may result in broken copper pipes or faults.

● When installing or transferring an air conditioner to another location, make sure that air other than the specified refrigerant (R32) does not enter the refrigeration cycle. If other air should enter, the pressure level of the refrigeration cycle may increase abnormally which could result in a rupture and injury.

● Never install a drier to this R32 unit in order to guarantee its lifetime.

● Be sure to ventilate fully if a refrigerant gas leak while at work. If the refrigerant gas comes into contact with fire, a poisonous gas may occur.

● After completion of installation work, check to make sure that there is no refrigeration gas leakage. If the refrigerant gas leaks into the room, coming into contact with fire in the fan-driven heater, space heater, etc., a poisonous gas may occur.

● Unauthorized modifications to the air conditioner may be dangerous. If a breakdown occurs, please call a qualified air conditioner technician or electrician. Improper repairs may result in water leakage, electric shock and fire, etc.

● Be sure to connect the earth line from the power supply wire to the outdoor unit and between the outdoor and indoor unit. Do not connect the earth line to the gas tube, water pipe, lightning rod or the earth line of telephone unit. Improper earthing may cause electric shocks.

The Choice of Mounting Site (Please note the following matters and obtain permission from customer before installation).

WARNING

● The Outdoor unit must be mounted at a location which can support heavy weight. Otherwise, noise and vibration will increase.

CAUTION

● Do not expose the unit under direct sunshine or rain. Besides, ventilation must be good and clear of obstruction.
● The air blown out of the unit should not point directly to animals or plants.
● The clearances of the unit from top, left, right and front are specified in figure below. At least 3 of the above sides must be open air.
● Be sure that the hot air blown out of the unit and noise do not disturb the neighbourhood.
● Do not install at a location where there is flammable gas, steam, oil and smoke.
● The location must be convenient for water drainage.
● Place the Outdoor unit and its connecting cord at least 1m away from the antenna or signal line of television, radio or telephone. This is to avoid noise interference.
● Do not install outdoor unit facing strong wind direction. It may damage the fan motor.
● Do not install the outdoor unit in a place where small animals may build their nests. If small animal goes inside the unit and touches the electrical parts, failure of the unit, smoke or fire may be caused. Request your customer to keep the surrounding of the unit is clean.

Names of Outdoor Components

No.	Item	Qty
①	Bush	2
②	Drain Pipe	1

Dimension of Mounting Stand of the Outdoor unit
(unit : mm)

Figure showing the Installation of Outdoor Unit.

● This unit is chargeless up 30m pipe length.
● Installation of pipe length less than minimum pipe length requirement (3 meters) may generate an abnormal sound.

CAUTION

● This unit is chargeless up 30m pipe length.
● Installation of pipe length less than minimum pipe length requirement (3 meters) may generate an abnormal sound.

WARNING

This symbol shows that this equipment uses a flammable refrigerant. If the refrigerant is leaked, together with an external ignition source, there is a possibility of ignition.

CAUTION

This symbol shows that the Operation Instructions should be read carefully.

CAUTION

This symbol shows that a service personnel should be handling this equipment with reference to the Installation Manual.

CAUTION

This symbol shows that there is information included in the Operation Manual and/or Installation Manual

Table 1: Minimum Floor area of the room A_{min} (m²)

Outdoor Model	Max Piping Length (m)	Max refrigerant charge amount (kg)	RAK-DJ**QHAE RAK-DJ**RHAE RAK-VJ**QHAE RAK-VJ**RHAE RAK-XJ**HAE RAK-XJ**RHAE	RAJ- RAD- RAD- RAD- RAJ- RAD- RAD- RAD-	Minimum Floor Area of the room (m ²)	RAF-XJ**QHAE RAF-XJ**RHAE Without SPX-RAFGLS (gas leak sensor) With SPX-RAFGLS (gas leak sensor)	
RAM-G110N5HAE	30	2.720	6.89	4.61	4.61	62.04	5.33
	75	3.300	10.30	6.89	6.89	92.68	6.51

** is referring to indoor model name.

BURST HAZARD

Do not allow air, etc. to get into refrigerant cycle (piping)

RISK OF EXPLOSION

Compressor must be stopped before removing refrigerant pipes.
All service valve must be fully closed after pumping down operation.

Height difference

Height difference between indoor units should not be more than 5m.

Piping length

(L1 + L2 + L3 + L4 + L5) = Maximum 75m
Minimum piping length for each indoor unit is 3m.
Maximum piping length for one indoor unit is 25m.
※ In case the pipe length is more than 30m, add refrigerant R32 at 13 gram per every meter exceeds

Height difference

Height difference between indoor units should not be more than 5m.

Piping length

(L1 + L2 + L3 + L4 + L5) = Maximum 75m
Minimum piping length for each indoor unit is 3m.
Maximum piping length for one indoor unit is 25m.
※ In case the pipe length is more than 30m, add refrigerant R32 at 13 gram per every meter exceeds

Outdoor unit installation

● Mount the Outdoor unit on stable ground to prevent vibration and increase of noise level.
● Decide the location for piping after sorting out the different types of pipe available.
● When removing side plate, pull the handle after releasing the hook by pulling it downward.

CONDENSED WATER DISPOSAL OF OUTDOOR UNIT

● There are holes on the base of Outdoor unit for condensed water to exhaust.
● In order to find condensed water to the drain, the unit is installed on a stand or a block so that the unit is 100mm above the ground as shown figure. Join the drain pipe to one hole.
● At first insert one portion of the hook to the base (Portion A), then pull the drain pipe in the direction shown by the arrow while inserting the hook into the base. After installation, check whether the drain pipe cling to the base firmly.

When Using and Installing In Cold Areas

When the air conditioner is used in low temperature and in snowy conditions, water from the heat exchanger may freeze on the base surface to cause poor drainage. When using the air conditioner in such areas, do not install the bushings. Keep a minimum of 250mm between the drain hole and the ground. When using the drain pipe, consult your sales agent.
※ For more details, refer to the installation Manual for Cold Areas.

REFRIGERANT INFORMATION				OPERATING RANGE		
MODEL	Refrigerant (kg)	GWP	tCO ₂ eq	Operation mode	Cooling / Dehumidifying	Heating
RAM-G110N5HAE	R32-2.720	675	1.836	Outdoor temperature	-10 to 46°C	-15 to 24°C

1. Proper place for installation

1.1 Outdoor unit

(1) Keep the space around the unit for maintenance and avoiding the effects of hindrance for normal ventilation of the unit.

(2) The northern or eastern side of the building is better to install. At the installation on the southern or western side unavoidably, some blind should be set up for the unit. (In this case, the blind must not obstruct the ventilation of the unit.)

(3) You'd better not put the unit at a place where is full of dirt and at a place where is wet in the rain.

(4) Place as near as possible to the indoor unit.

(5) Install the unit in a stable place to minimize vibration or noise.

(6) After arranging the cords and pipes, secure them in place.

WARNING

● This appliance must be earthed.
● Power is supplied through outdoor unit, do not connect power source to indoor unit.

2. In the electrical installation a separator with a contact gap of more than 3mm has to be installed. During cleaning or service the set has to be switched off with this separator.

1 Preparation of Pipe

● Use a pipe cutter to cut the copper pipe.

CAUTION

● Jagged edge will cause leakage.
● Point the side to be trimmed downwards during trimming to prevent copper chips from entering the pipe.

● Before flaring, please put on the flare nut.

● Recommend to use R32 flaring tool.

Outer Diameter mm (inch)	Thickness (mm)	Flare tool for R32 Clutch type	Conventional flare tool Clutch type	Wing nut type
6.35 (1/4")	0.8	0.0 ~ 0.5	1.0 ~ 1.5	1.5 ~ 2.0
9.52 (3/8")	0.8	0.0 ~ 0.5	1.0 ~ 1.5	1.5 ~ 2.0
12.70 (1/2")	0.8	0.0 ~ 0.5	1.0 ~ 1.5	1.5 ~ 2.5
15.88 (5/8")	1.0	0.0 ~ 0.5	1.0 ~ 1.5	1.5 ~ 2.5

3 Removal Of Air From The Pipe And Gas Leakage Inspection

1. Air purging by using vacuum pump

Remove the valve cap from the service valves located at both the large and small pipe rims.

After removing the valve cap of the valve core of the service valves located at the large pipe rim, connect the charging hose A.

After connecting the vacuum suction pump adaptor, connect the charging hose B to the adaptor.

During relocation or at any one time when the air conditioner unit is removed and re-installed, there is a possibility of getting a closed electric-powered valve. Should the electric-powered valve be closed, even with air purging being conducted, certain amount of air is still trapped within that area, hence, there is a need to open up the electric-powered valve to do an air purging. Under such circumstances, before using the vacuum-suction pump, the main power supply (LN terminal) should be connected to enable a complete opening up of the valve. After connecting the power supply for approximately 90 seconds, the valve will be fully opened up, after which disconnect the power supply and start using the vacuum suction pump.

CAUTION: Ingress of air during the operating cycle may cause increase in pressure and other breakdowns.

Switch off the outdoor unit's power supply

Shutting off via the manifold valve handle "Hi", the handle "Lo" will open up and operate the vacuum pump that will run a vacuum suction for approximately 60 minutes.

Upon a full shut off via the manifold valve handle "Lo", the vacuum pump will stop operating.

Check to ensure that there is no gas leakage.

After removing the charging hose A, rotate the service valve spindles (2 units on both sides) in an anti-clockwise direction to fully open up.

Reinstall the cap nuts to their original positions and tighten them to their specified torque values.

Disconnect the charging hose from the service valve.

Tighten the valve cap of valve core. (Torque 12.3 - 15.7 N·m (125 - 160 kgf·cm))

Attach the valve cap to the spindles of each large and small dia. pipe side service valves.

Tighten the valve cap of the spindle. (Torque 19.6 - 24.5 N·m (200 - 250 kgf·cm))

Air purging by vacuum pump

When the meter reaches -101kPa (-76cmHg) during pumping, fully tighten the shutle.

Be sure the stop valve is always fully opened.

The refrigerant channel is opened so that the refrigerant will flow from the outdoor unit into the indoor unit.

CAUTION

● Prevent moisture from entering pipe connection.
● Refrigerating machine oil not be applied to the outside of the flare.
When refrigerating machine oil is applied to the outside of the flare, excessive tightening of the flare nut, cracking of the flare nut, destruction of the flare and gas leakage may occur.
● da e a i l d d t e r t e t e e e e a e a e r e e r e a e a e f i e r e a e a e i e i l i e

Gas Leakage Inspection

Please use gas leakage detector to check if leakage occurs at the connection of Flare nut as shown on the right.

If gas leakage occurs, further tighten the connection to stop leakage. (Be sure to use R32 detector)

WARNING

● THIS APPLIANCE MUST BE EARTHED.

Procedures of Wiring

1. Installation procedure and notice

Especially, the selection of installation place need great care for the split type air conditioner, because it is very difficult to move from place to place after the first installation.

1.1 Wiring

(1) Those terminal blocks for connecting the indoor and outdoor cables should be installed starting from the righthand side, in a sequence of 1, 2, 3, 4, 5, in accordance with the units' numbering system, as illustrated in the diagram. The left hand-most terminal block is for the power supply connection use.

(2) Connect the electrical wiring between the Indoor and Outdoor unit, as shown in Fig. 1-1. Never connect the wiring by mistake.

(3) In case of wrong connection, the unit does not operate properly and it may cause malfunction.

(4) The connecting cord must be fixed by the band which is located near the terminal board.

1.2 Connection of the connecting cords and power cord

(1) Cut off the connecting cord, the power cord and strip the insulation of the wire, as shown in Fig. 1-2.

(2) Connect the connecting cord and power cord to the terminal board. (Fig. 1-3-2)

(3) Fix the connecting cords and power cord with steel band carefully. (Fig. 1-3-2)

Wiring Pattern

Fig. 1-1

Detail of Cutting the Connecting Cord

WARNING

● Leave some space in the connecting cord for maintenance purpose and be sure to secure it with the cord band.

● Secure the connecting cord along the coated part of the wire using the cord band. Do not exert pressure on the wire as this may cause overheating or fire.

WARNING

● The naked part of the wire core should be 10 mm and fix it to the terminal tightly. Then try to pull the individual wire to check if the contact is tight. Improper insertion may burn the terminal.

● Be sure to use only wire specified for the use of air-conditioner.

● Please refer to the manual for wire connection and the wiring technique should meet the standard of the electrical installation.

● There is an AC voltage drop between the LN terminal if the power is on. Therefore, be sure to remove the plug from its socket.

Fig. 1-2

Fig. 1-3-1

Fig. 1-3-2

CAUTION

Arrange power cord so they do not touch service valve.

CAUTION

Note: ● Outdoor supply cords shall not be lighter than polychloroprene sheathed flexible cord with code designation 60245 IEC 57.

1 Insulation And Maintenance Of Pipe Connection

● The connected terminals should be completely sealed with heat insulator and then tied up with rubber strap.

● Please tie the pipe and power line together with vinyl tape as shown in the figure showing the installation of Indoor and Outdoor units. Then fix their position with holders.

● To enhance the heat insulation and to prevent water condensation, please cover the outdoor part of the drain hose and pipe with insulation pipe.

● Completely seal any gap with putty.

CAUTION

● Please use a new socket. Accident may occur due to the use of old socket because of poor contact.
● Please plug in and then remove the plug for 2 - 3 times. This is to ensure that the plug is completely plugged into the socket.
● Keep additional length for the power cord and do not render the plug under external force as this may cause poor contact.
● Do not fix x the power cord with U-shape nail.

Operation Test

● Please ensure that the air conditioner is in normal operating condition during the operation test.

● Explain to your customer the proper operation procedures as described in the user's manual.

● During test operation, each unit must be operated separately and ensure normal operation.connections are correct.

● If the indoor unit does not operate, check to see that the Please be sure to measure the supply voltage before operation test. Please ensure that the air conditioner is in normal operating condition during the operation test.

1. Operate with Cooling Mode(in summer) or Heating Mode(in winter).

2. Press Temperature Button on the remote controller to set the desired temperature to 16.0°C for Cooling Mode or 32.0°C for Heating Mode. Set the desired fan speed to " (High)." (High).

3. Operate the air conditioner for 20 minutes at least and make sure that the air from the air conditioner is cool or warm.

2 Power Source And Operation Test

Power Source

4. Press On/Off Button on the remote controller and make sure that the air conditioner stops If the indication lamps of the indoor unit flash with sounding of the buzzer during the operation test, following the procedures below.

Indication lamps flashing mode

What to check

● All indication lamps flash three times repeatedly. (Outdoor fan might operate for near 15 minutes after the operation stop for the protection. For the reoperation at that case, do it after outdoor fan will stop.)

Make sure that the spindles of both service valves are open. (Outdoor fan might operate for near 15 minutes after the operation stop for the protection. For the reoperation at that case, do it after outdoor fan will stop.)

CAUTION

Reuse of piping R410A model only apply if previous model is Hitachi and proper pump down method is used.

To Reuse Old Piping

● Piping of R410A model can be reused only when air-conditioner is properly pumped down.

● The purpose of pump down is to collect back the compressor oil (which is mixed with refrigerant and circulating inside refrigeration cycle) properly into the outdoor unit of air conditioner.

Possibility of Mixing

● Reuse of piping of R410A model is dangerous because of its compressor oil.

● When reuse piping of R410A model, pump down must be carried out properly to ensure compressor oil which is remained inside piping is collected away.

CAUTION

Reuse of piping R410A model only apply if previous model is Hitachi and proper pump down method is used.

To Reuse Old Piping

● Piping of R410A model can be reused only when air-conditioner is properly pumped down.

● The purpose of pump down is to collect back the compressor oil (which is mixed with refrigerant and circulating inside refrigeration cycle) properly into the outdoor unit of air conditioner.

Possibility of Mixing

● Reuse of piping of R410A model is dangerous because of its compressor oil.

● When reuse piping of R410A model, pump down must be carried out properly to ensure compressor oil which is remained inside piping is collected away.

- 1 -

- 2 -