

1. Outdoor Unit

1-2. Dimensional Data

U-4LZ2E5, U-5LZ2E5, U-6LZ2E5
U-4LZ2E8, U-5LZ2E8, U-6LZ2E8

Unit: mm

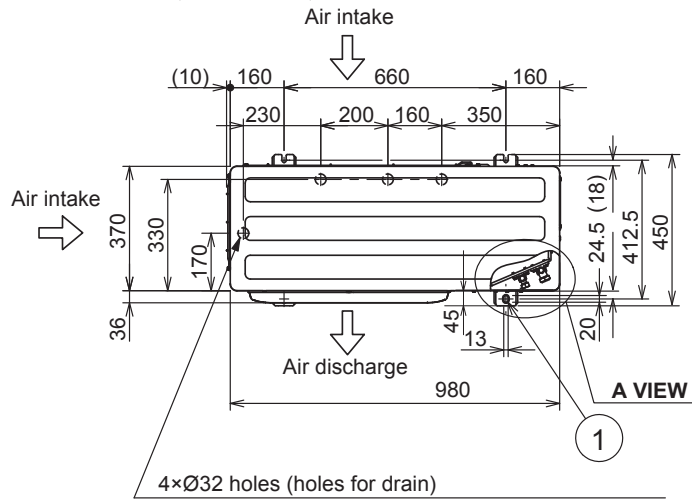

①	Mounting hole (4-R6.5), anchor bolt : M10
②	Refrigerant tubing (liquid tube), flared connection (Ø9.52)
③	Refrigerant tubing (gas tube), flared connection (Ø15.88)
④	Refrigerant tubing port
⑤	Electrical wiring port (Ø13)
⑥	Electrical wiring port (Ø22)
⑦	Electrical wiring port (Ø27)
⑧	Electrical wiring port (Ø35)

When using a drain pipe, install the drain socket (field supply) on to the drain port. Seal the other drain port with the rubber cap.

4

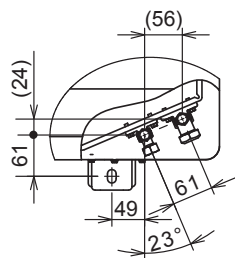
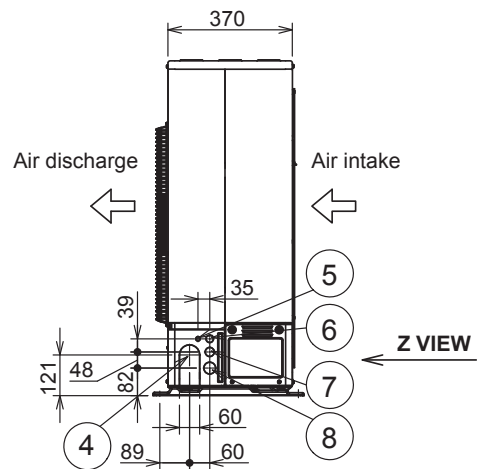
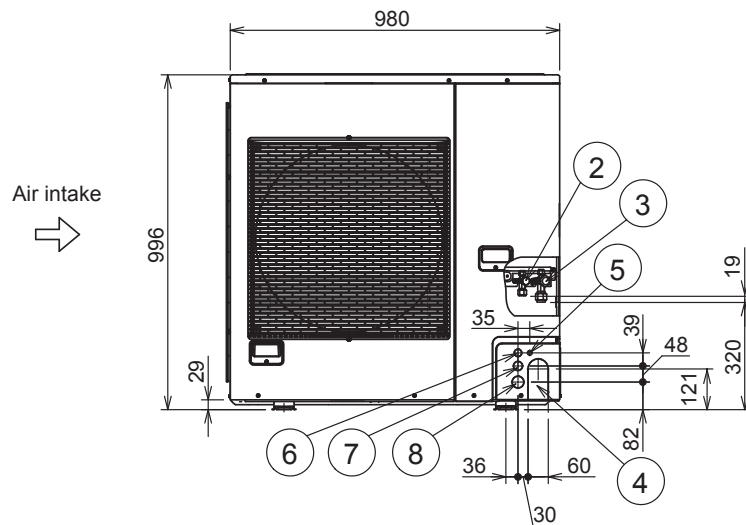

A VIEW

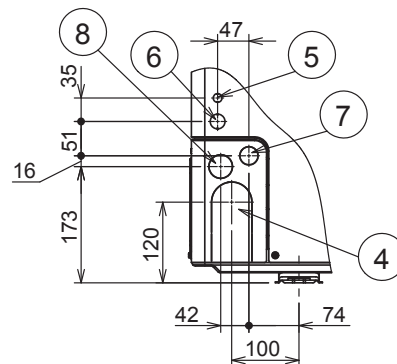

Z VIEW

1. Outdoor Unit

1-2. Dimensional Data U-8LZ2E8

Unit: mm

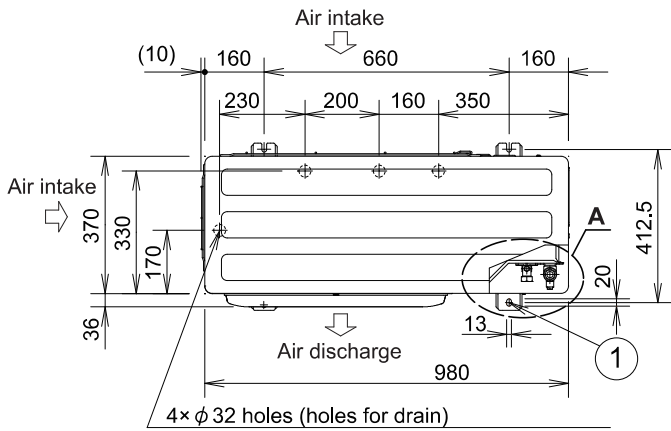

When using a drain pipe, install the drain socket (field supply) onto the drain port. Seal the other drain port with the rubber cap.

①	Mounting hole (4-R6.5), anchor bolt : M10
②	Refrigerant tubing (liquid tube), flared connection (ϕ 9.52)
③	Refrigerant tubing (gas tube), flared connection (ϕ 19.05)
④	Refrigerant tubing port
⑤	Electrical wiring port (ϕ 13)
⑥	Electrical wiring port (ϕ 22)
⑦	Electrical wiring port (ϕ 27)
⑧	Electrical wiring port (ϕ 35)

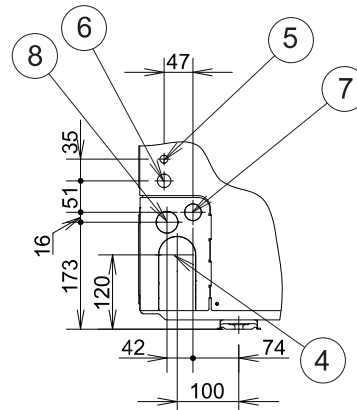
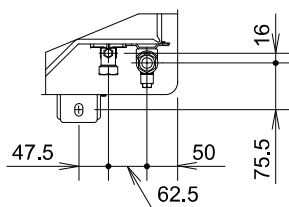
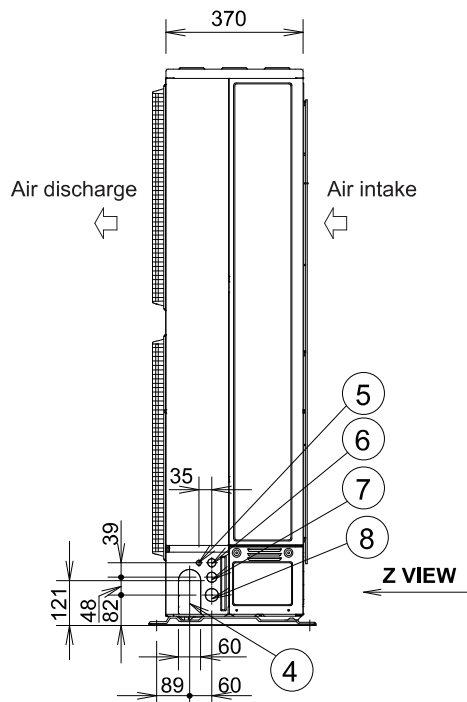
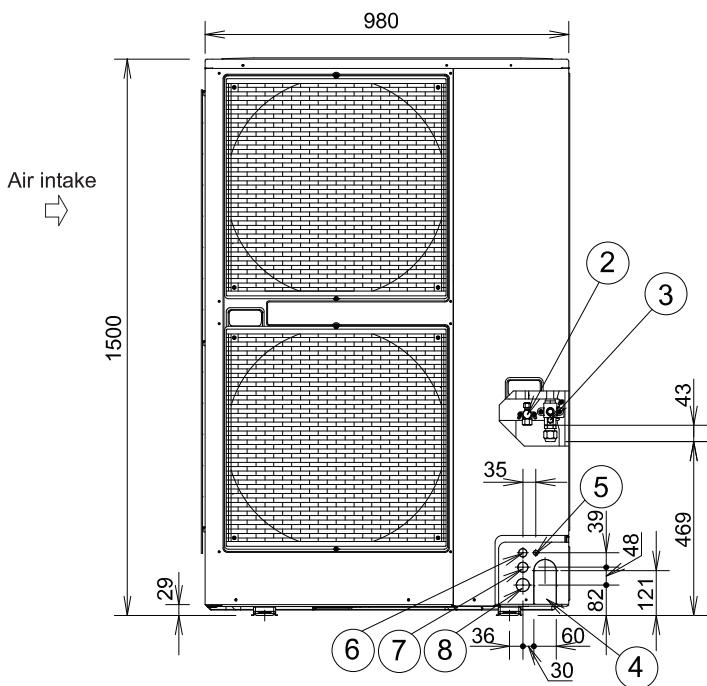

1. Outdoor Unit

1-2. Dimensional Data U-10LZ2E8

Unit: mm

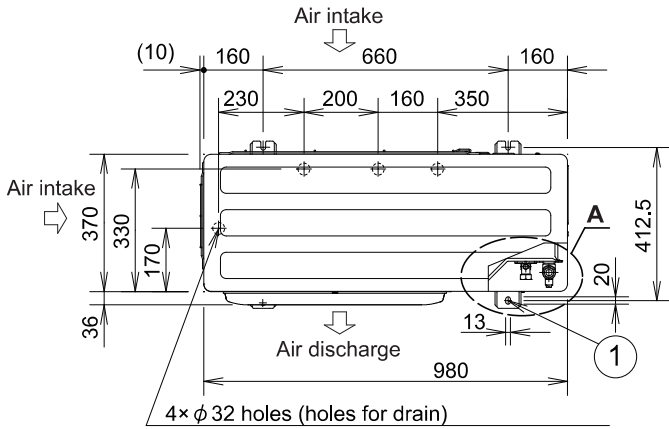

When using a drain pipe, install the drain socket (field supply) onto the drain port. Seal the other drain port with the rubber cap.

①	Mounting hole (4-R6.5), anchor bolt : M10
②	Refrigerant tubing (liquid tube), flared connection (ø9.52)
③	Refrigerant tubing (gas tube), flared connection (ø19.05)
④	Refrigerant tubing port
⑤	Electrical wiring port (ø13)
⑥	Electrical wiring port (ø22)
⑦	Electrical wiring port (ø27)
⑧	Electrical wiring port (ø35)

The tubing of the gas main has a diameter of ø22.22, but the connection to the service valve of the outdoor unit has a diameter of ø19.05, so a flare has to be used. Consequently, be sure to use the enclosed joint tube B and joint tube A in making connections (braze).

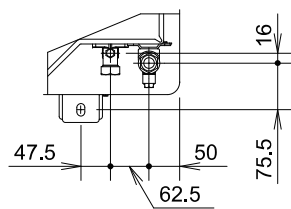
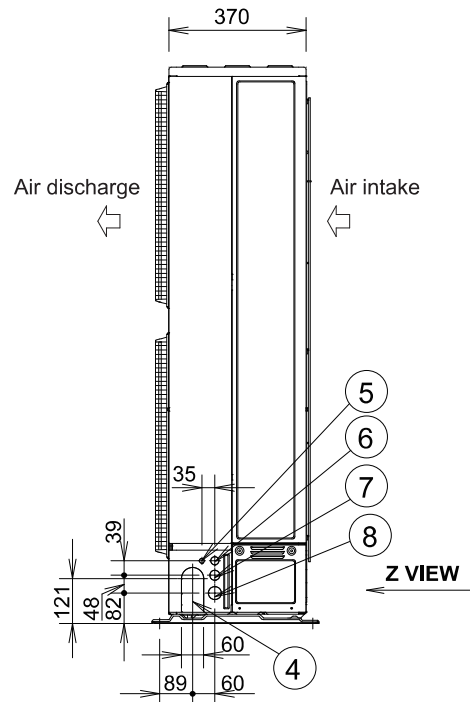
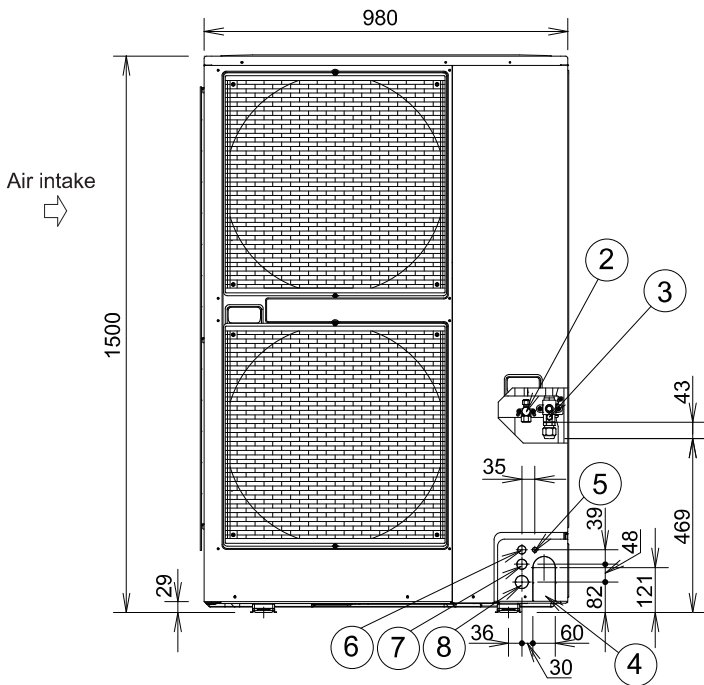

A VIEW

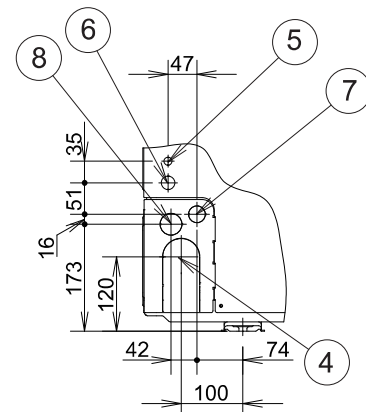

Z VIEW

1. Outdoor Unit

1-3. Position of Center of Gravity U-8LZ2E8, U-10LZ2E8

Unit: mm

Weight

Model	Weight
	(kg)
U-8LZ2E8	125
U-10LZ2E8	126

