

18. Dimensions (mm)

18.1. ECOi-W 140 to 210 without pump

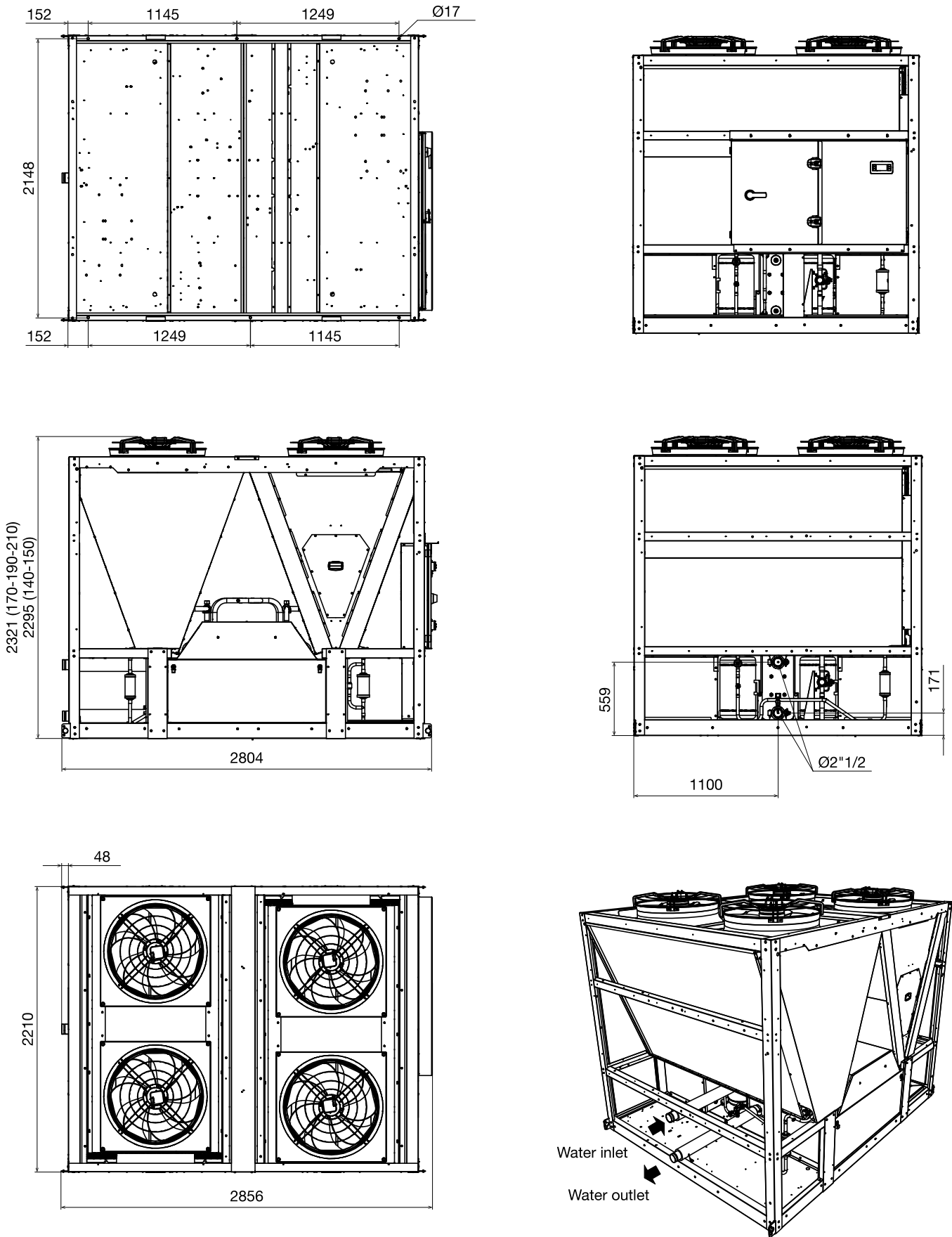

18.2. ECOi-W 140 to 210 with 1 pump

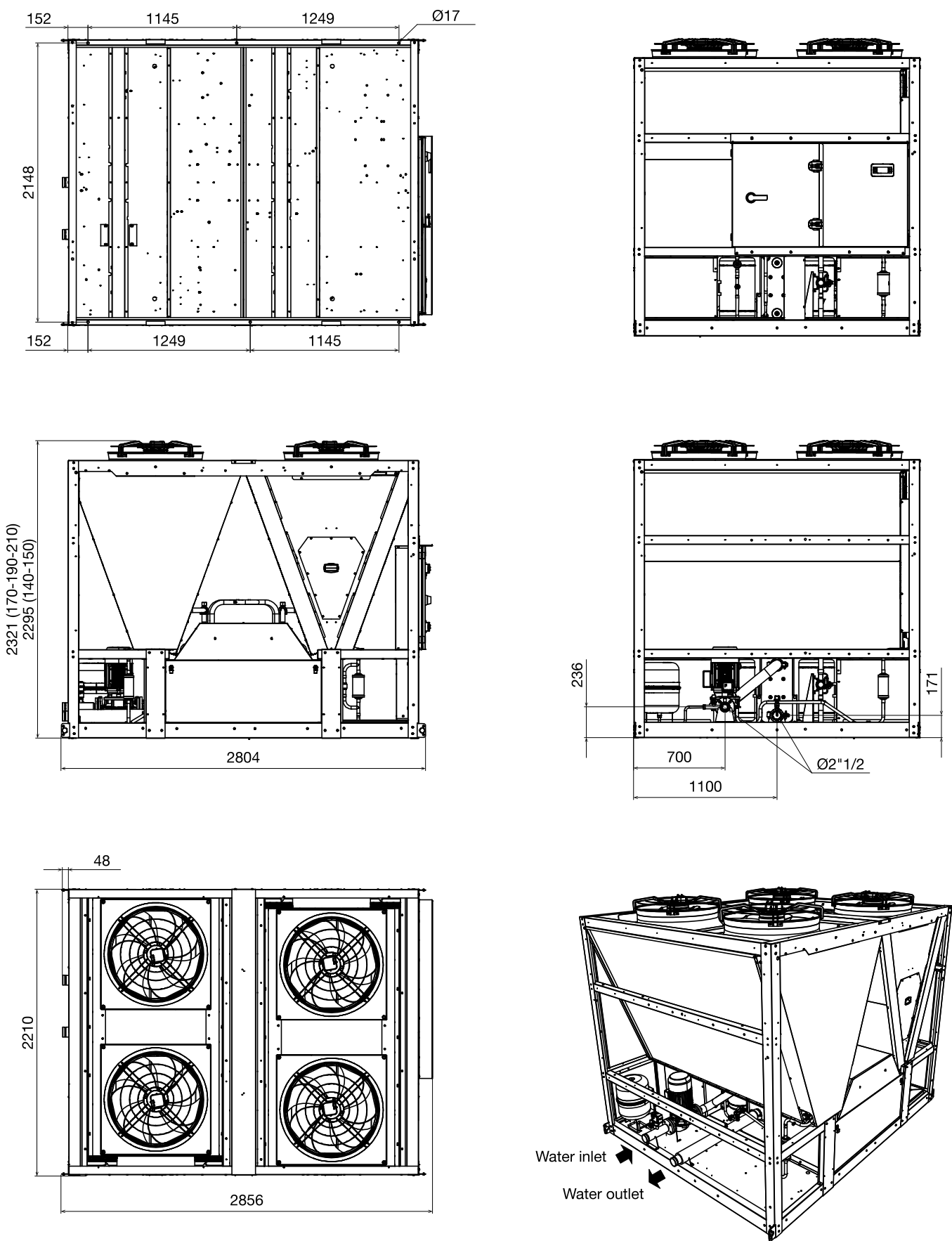

18.3. ECOi-W 140 to 210 with 2 pumps

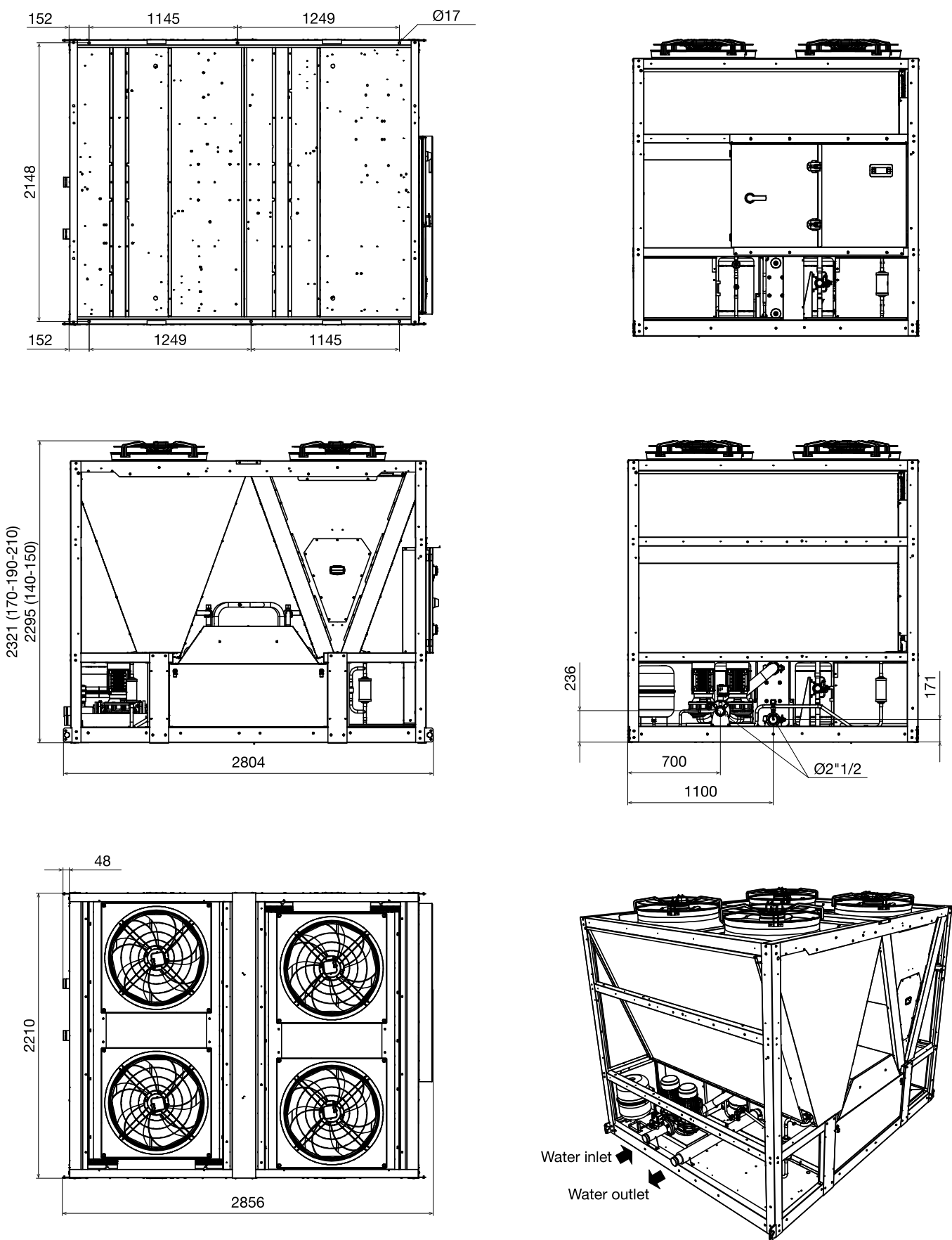

18.4. ECOi-W 140 to 210 with 1 pump and buffer tank

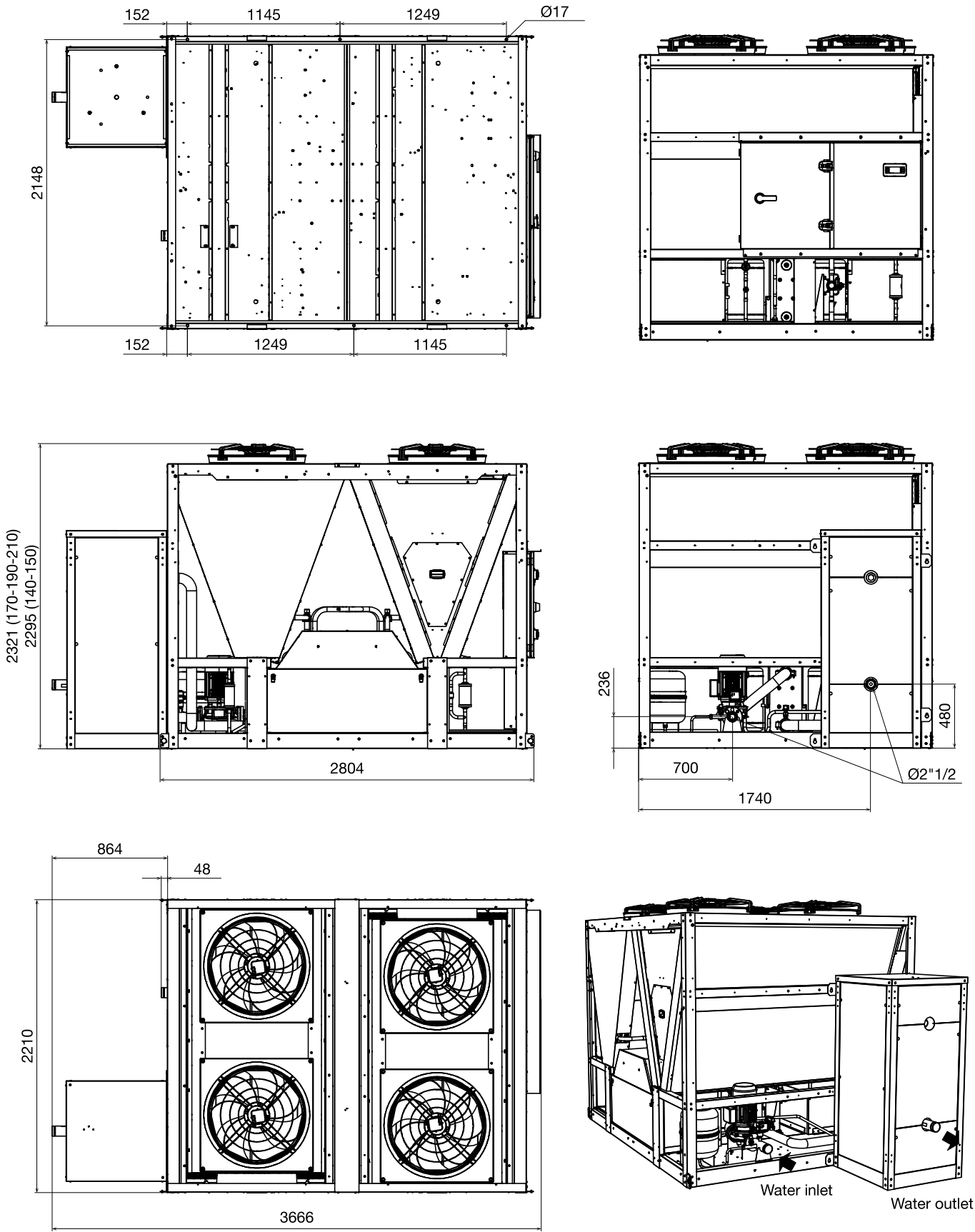

18.5. ECOi-W 140 to 210 with 2 pumps and buffer tank

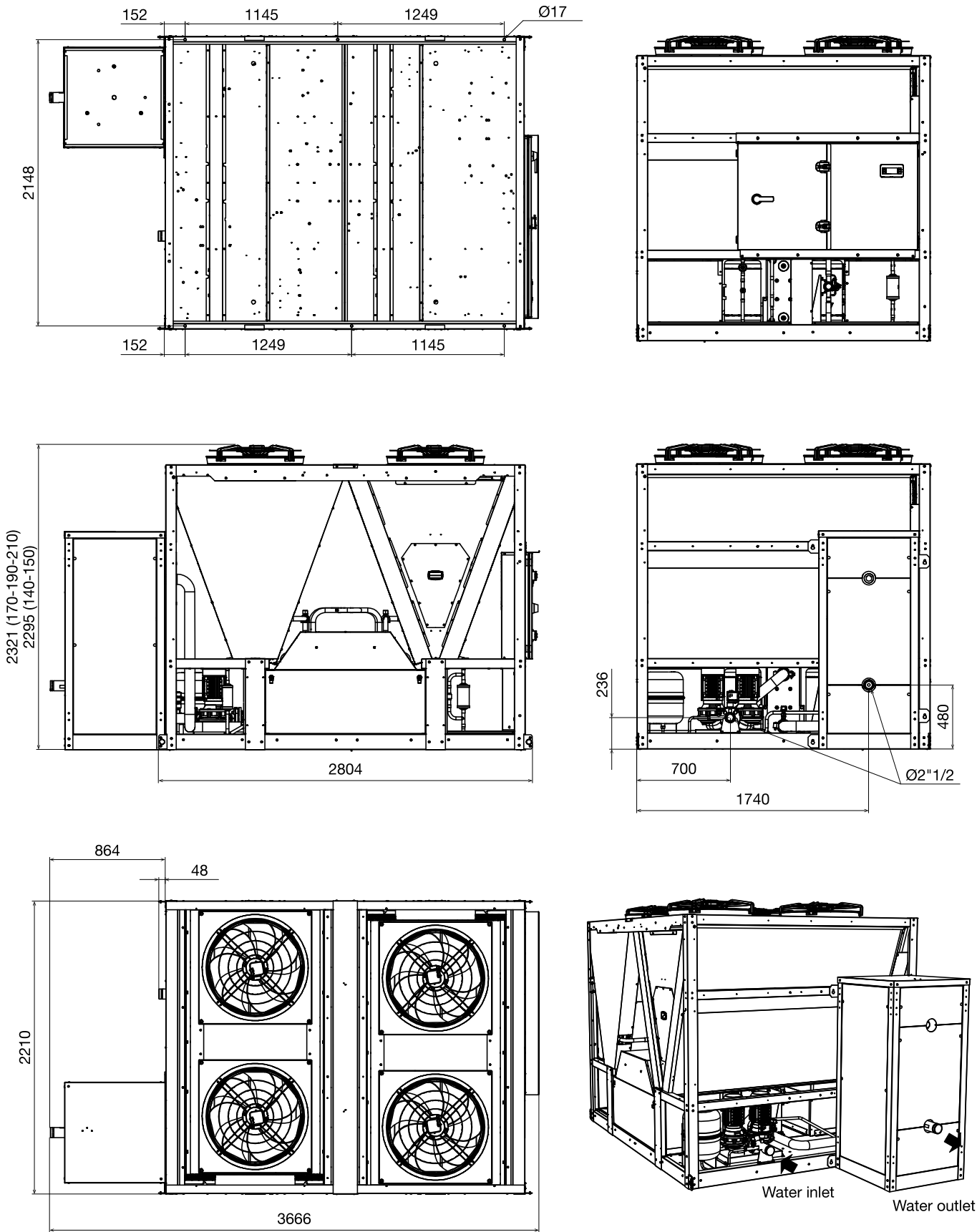

19. Space Requirements (mm)

19.1. ECOi-W 140 to 210 without buffer tank

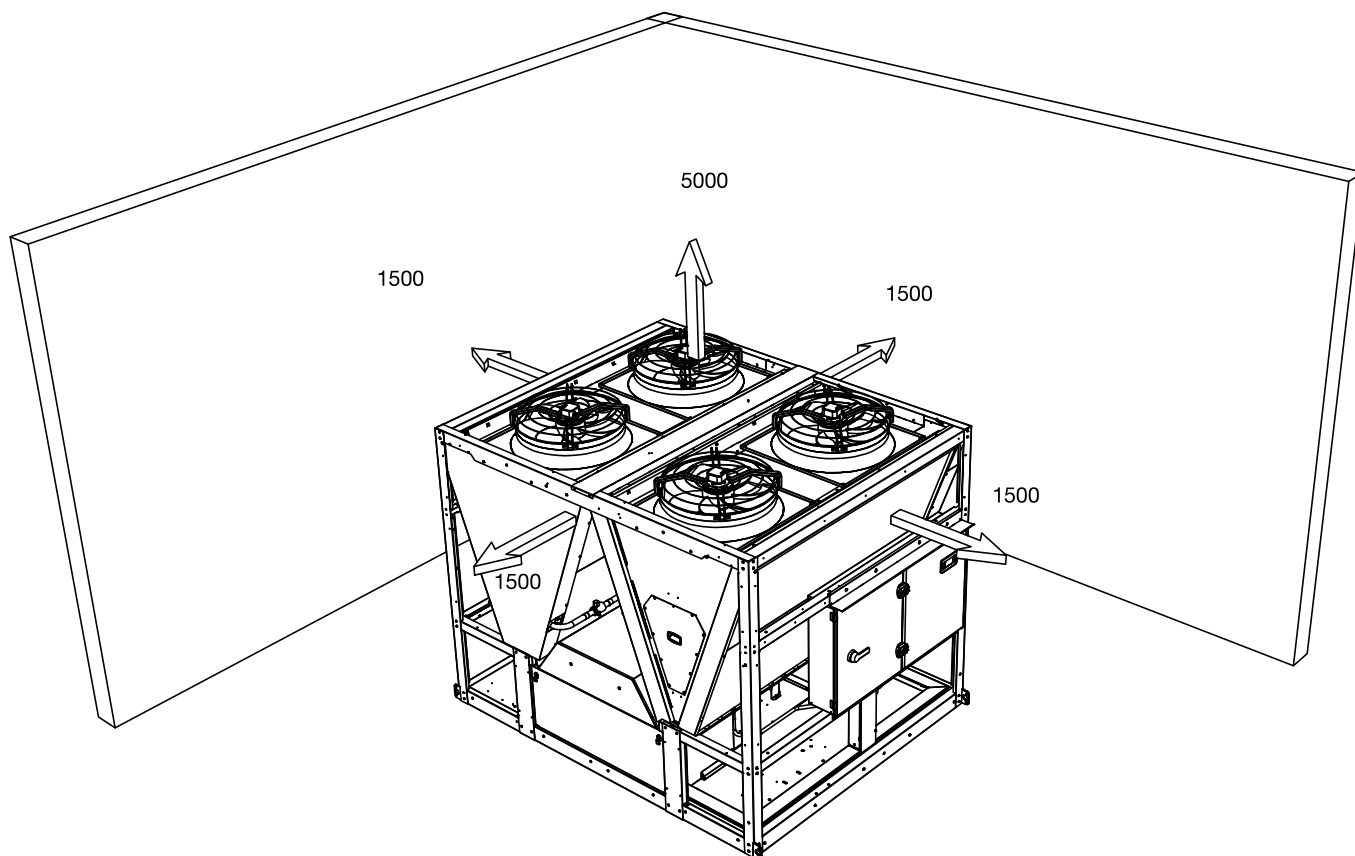

19.2. ECOi-W 140 to 210 with buffer tank

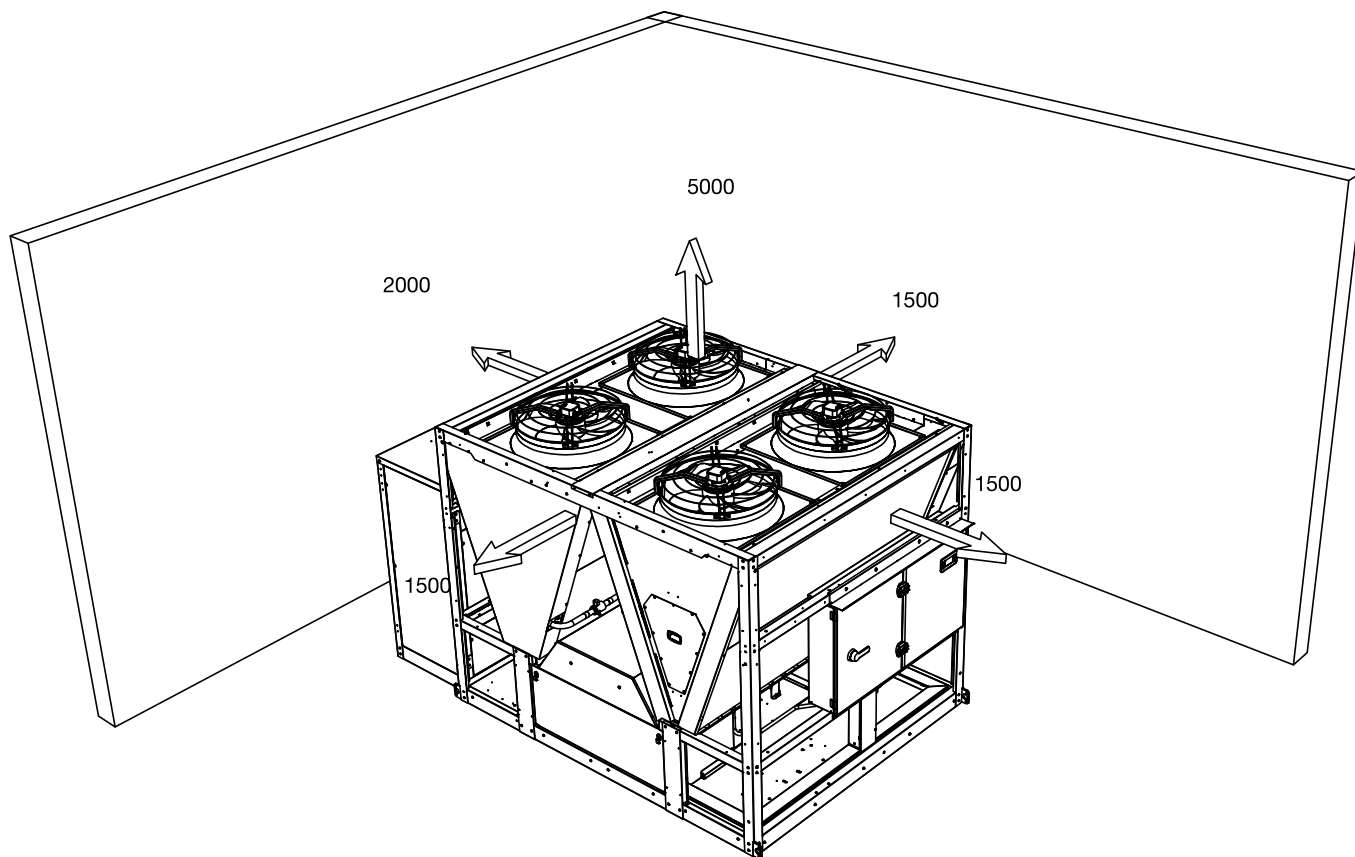

20. Mass distributions

20.1. ECOi-W 140 to 210 without buffer tank

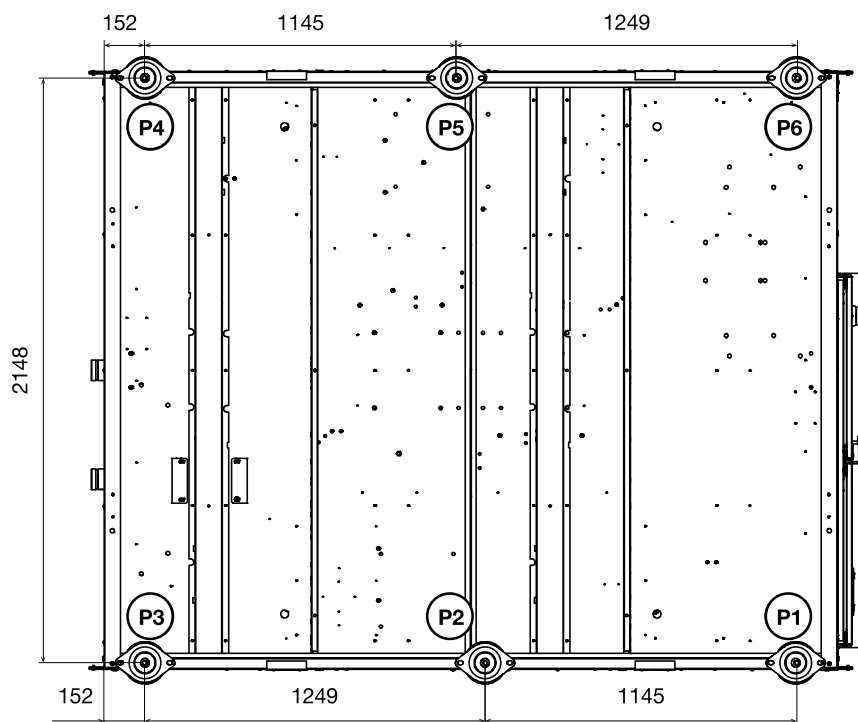

	Rubber pads						
	M	P1	P2	P3	P4	P5	P6
	kg	kg	kg	kg	kg	kg	kg
140.HB	1440	270	250	220	210	230	260
140.H1BP	1530	280	270	260	230	240	250
140.H1HP	1560	280	280	270	240	240	250
140.H2BP	1550	280	270	270	240	240	250
140.H2HP	1590	280	280	280	250	250	240
150.HB	1440	270	250	220	210	230	260
150.H1BP	1530	280	270	260	230	240	250
150.H1HP	1560	280	280	270	240	240	250
150.H2BP	1550	280	270	270	240	240	250
150.H2HP	1590	280	280	290	250	250	250
170.HB	1530	300	270	250	210	240	260
170.H1BP	1630	300	300	290	240	250	250
170.H1HP	1660	300	300	300	250	250	250
170.H2BP	1640	300	300	300	240	250	250
170.H2HP	1690	310	310	310	260	250	250
190.HB	1600	300	280	250	230	260	280
190.H1BP	1700	310	300	290	260	270	280
190.H1HP	1740	310	310	310	270	270	270
190.H2BP	1710	310	300	300	260	270	270
190.H2HP	1760	310	310	310	280	270	270
210.HB	1870	340	320	290	280	300	330
210.H1BP	1960	400	340	280	250	310	370
210.H1HP	2000	420	350	280	250	320	380
210.H2BP	1970	350	340	340	310	310	320
210.H2HP	2020	350	350	360	320	320	320

	Spring damper						
	M	P1	P2	P3	P4	P5	P6
	kg	kg	kg	kg	kg	kg	kg
140.HB	1590	300	280	250	230	260	280
140.H1BP	1680	300	300	290	260	260	270
140.H1HP	1720	300	310	310	270	270	270
140.H2BP	1700	310	300	290	260	270	270
140.H2HP	1740	310	310	310	270	270	270
150.HB	1610	300	280	250	230	260	280
150.H1BP	1700	310	300	290	260	270	270
150.H1HP	1740	310	310	310	270	270	270
150.H2BP	1720	310	300	300	260	270	280
150.H2HP	1760	310	310	310	270	270	270
170.HB	1710	320	300	270	250	270	300
170.H1BP	1800	330	320	310	270	280	290
170.H1HP	1830	330	330	330	280	280	280
170.H2BP	1810	330	320	310	280	280	290
170.H2HP	1860	330	330	330	290	290	290
190.HB	1800	340	310	280	260	290	320
190.H1BP	1890	340	330	330	290	300	300
190.H1HP	1930	340	340	340	300	300	300
190.H2BP	1900	340	340	330	290	300	310
190.H2HP	1950	350	350	350	300	300	300
210.HB	2110	400	360	330	310	340	370
210.H1BP	2200	400	390	380	340	340	350
210.H1HP	2240	400	400	400	350	350	350
210.H2BP	2210	400	390	380	340	350	360
210.H2HP	2260	400	400	400	350	350	350

HB: No Pump.
H1BP: Single Pump Low Pressure.
H1HP: Single Pump High Pressure.

H2BP: Double Pump Low Pressure.
H2HP: Double Pump High Pressure.

20.2. ECOi-W 140 to 210 with buffer tank

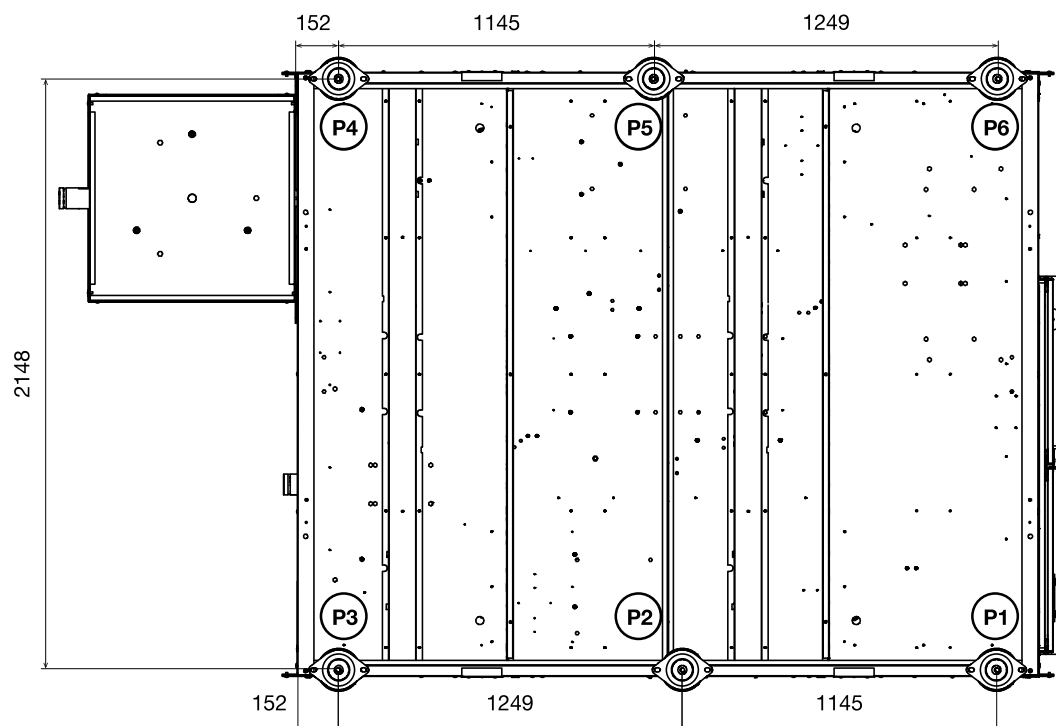

	Rubber pads						
	M	P1	P2	P3	P4	P5	P6
	kg	kg	kg	kg	kg	kg	kg
140.HB	1590	300	270	250	230	260	280
140.H1BP	1680	310	300	290	260	270	280
140.H1HP	1720	310	300	300	270	270	270
140.H2BP	1700	310	300	290	260	270	270
140.H2HP	1740	310	310	310	270	270	270
150.HB	1610	300	280	250	230	260	290
150.H1BP	1700	310	300	290	260	270	280
150.H1HP	1740	310	310	300	270	270	280
150.H2BP	1720	310	300	300	260	270	280
150.H2HP	1760	310	310	310	280	280	270
170.HB	1710	330	300	280	240	270	290
170.H1BP	1800	330	320	320	270	270	280
170.H1HP	1830	330	330	330	280	280	280
170.H2BP	1810	330	330	320	270	280	280
170.H2HP	1860	330	340	340	280	280	280
190.HB	1800	330	310	280	270	290	320
190.H1BP	1890	340	330	320	290	300	310
190.H1HP	1930	340	340	340	300	300	300
190.H2BP	1900	340	330	330	300	300	310
190.H2HP	1950	340	340	350	310	310	300
210.HB	2110	380	360	330	320	340	370
210.H1BP	2200	440	380	320	290	350	410
210.H1HP	2240	460	390	320	290	360	420
210.H2BP	2210	390	390	380	350	350	360
210.H2HP	2260	390	400	400	360	360	360

	Spring damper						
	M	P1	P2	P3	P4	P5	P6
	kg	kg	kg	kg	kg	kg	kg
140.HB	2030	240	240	440	530	290	290
140.H1BP	2120	250	260	490	550	290	290
140.H1HP	2160	250	260	500	560	300	280
140.H2BP	2140	250	260	490	560	300	290
140.H2HP	2180	250	270	510	570	300	290
150.HB	2050	240	240	450	530	290	290
150.H1BP	2140	250	260	490	560	300	290
150.H1HP	2170	250	260	510	570	300	290
150.H2BP	2160	250	260	490	560	300	290
150.H2HP	2200	250	270	510	580	300	290
170.HB	2150	260	250	470	560	310	310
170.H1BP	2240	260	270	510	580	310	300
170.H1HP	2270	260	280	530	590	310	300
170.H2BP	2250	260	270	520	590	310	300
170.H2HP	2300	270	280	540	600	310	300
190.HB	2240	270	270	480	580	320	320
190.H1BP	2330	270	280	530	610	320	310
190.H1HP	2370	270	290	550	620	320	310
190.H2BP	2340	270	280	540	610	320	310
190.H2HP	2390	280	290	560	620	330	310
210.HB	2550	300	300	550	660	360	360
210.H1BP	2640	310	320	600	690	370	350
210.H1HP	2680	310	330	620	700	370	350
210.H2BP	2650	310	320	610	690	370	360
210.H2HP	2700	310	330	630	710	370	350

HB: No Pump.
H1BP: Single Pump Low Pressure.
H1HP: Single Pump High Pressure.

H2BP: Double Pump Low Pressure.
H2HP: Double Pump High Pressure.