

How to separate the indoor unit

1. Remove the wire cover.

(1) Loosen two screws.

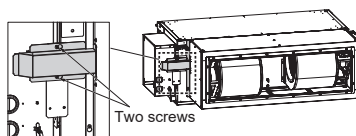

(2) Move to the left and remove the wire cover through the round hole.

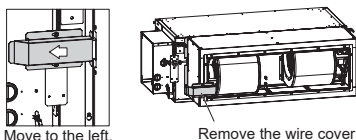

2. Remove the fan cover unit.

(1) Loosen four screws.

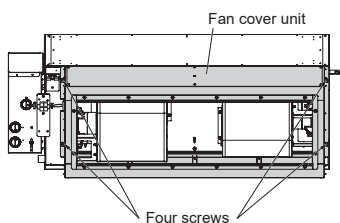

(2) Move the fan cover unit upward and remove it through the round hole.

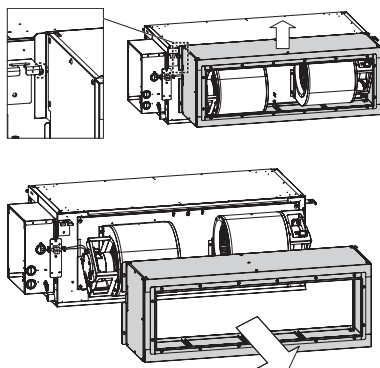

3. Remove the motor relay connector.

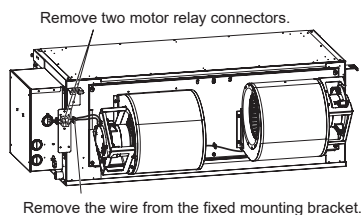

Remove the wire from the fixed mounting bracket.

4. Separate the fan motor unit and heat exchanger unit.

(1) Loosen the upper side three bolts and remove the lower side three bolts.



WARNING

Do not remove the upper side three bolts. The motor unit may drop during work of unit separation and can lead to personal injury or death.

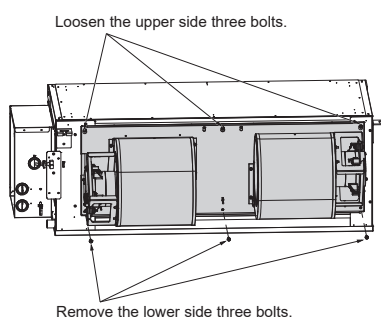

(2) Move upward and remove the fan motor unit through the round hole.

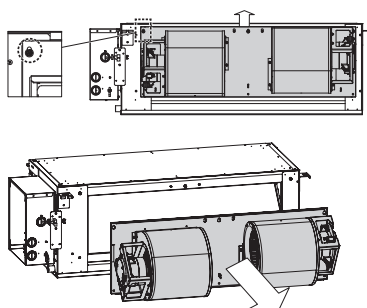

How to assemble the indoor unit

1. Attach the fan motor unit.

(1) Pass the bolts for the heat exchanger unit through the round holes.

Mount the unit with three holes located in the center of the upper side.

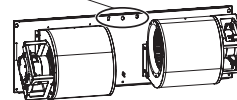

(2) Attach three bolts in the lower side and then fasten three bolts in the upper side. (Tightening torque : 2.45 ~ 3.4 N · m)

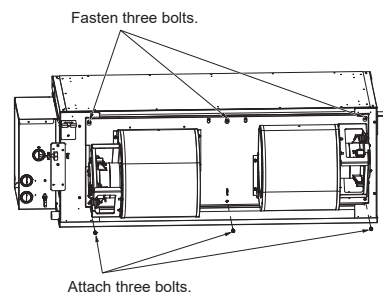

(3) Attach the motor wire.

Attach two motor connectors. (Connectors at each end should be matched with the same color.)

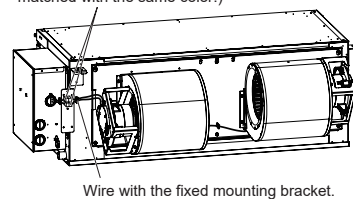

2. Attach the fan cover unit and wire cover. Attach the fan cover unit and wire cover in reverse order of separating unit.